

ENGINE GROUP

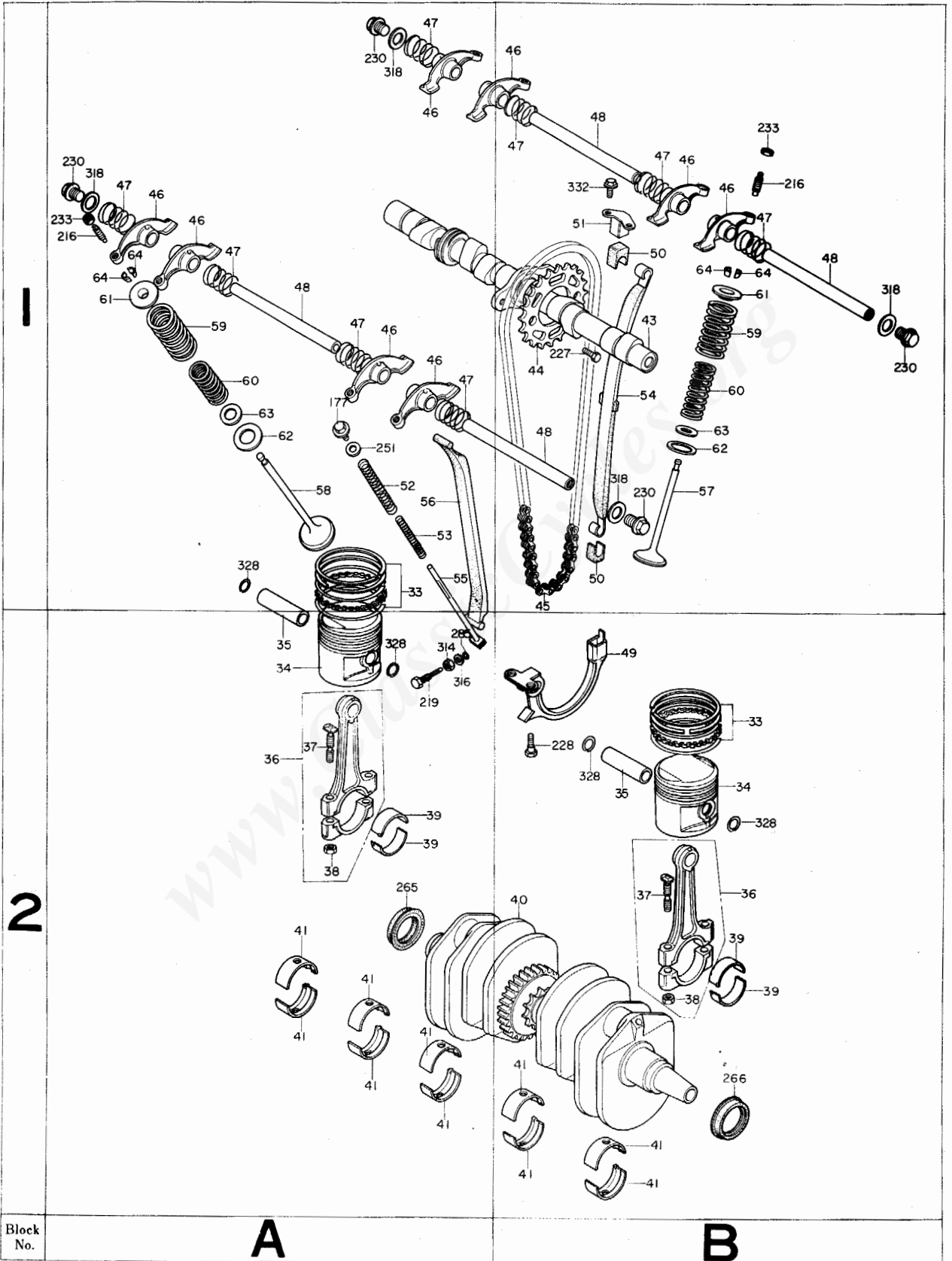

Block No.

A

B

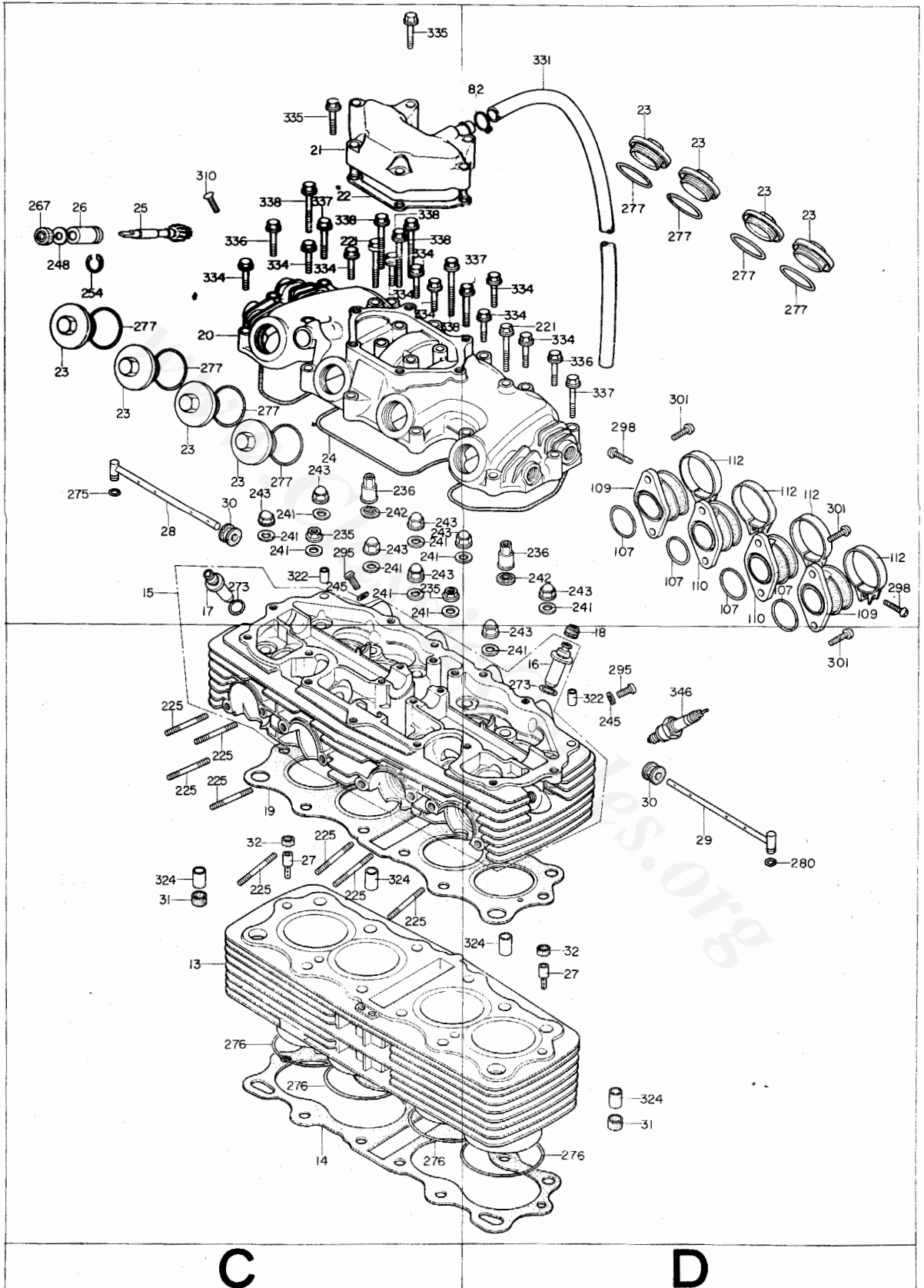

ENGINE GROUP

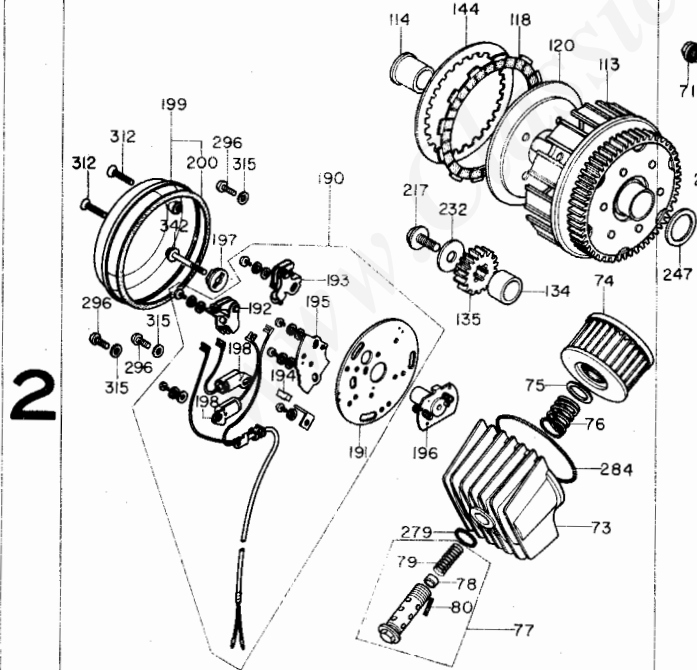
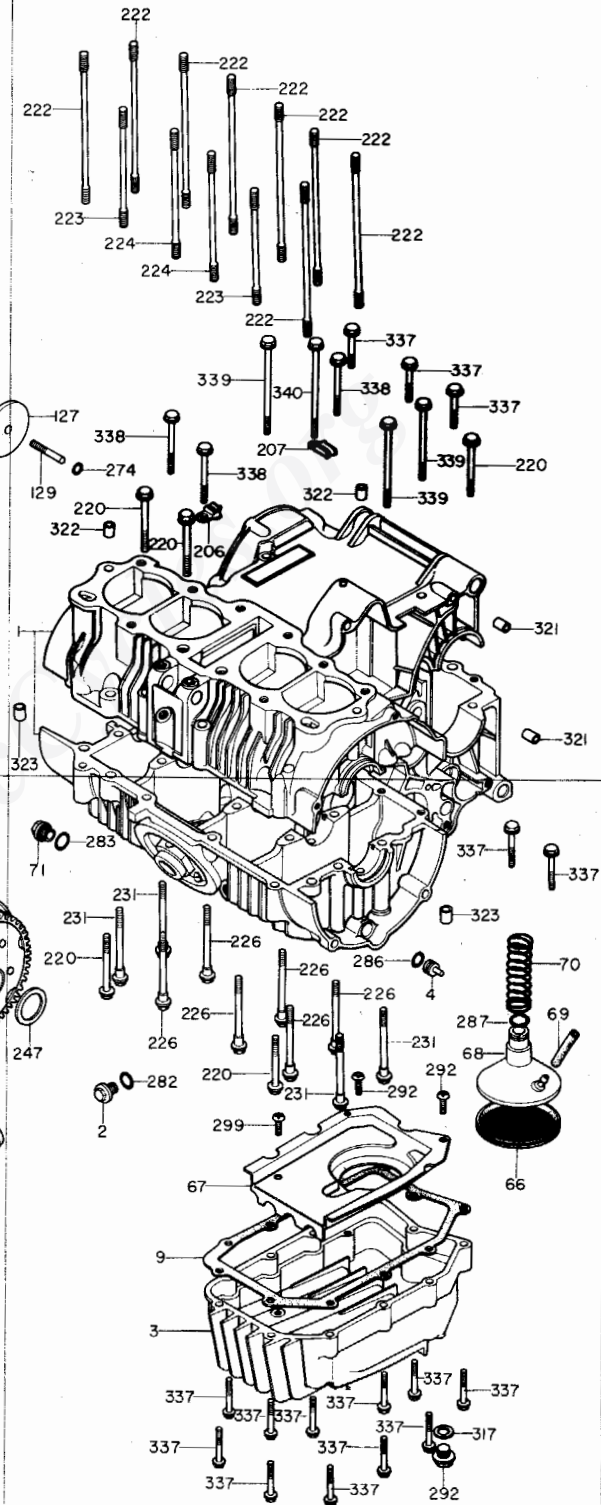
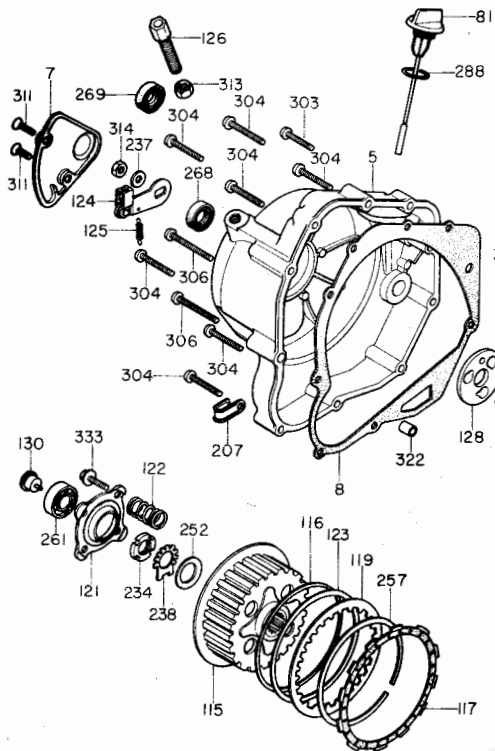

2

Block No.

E

F

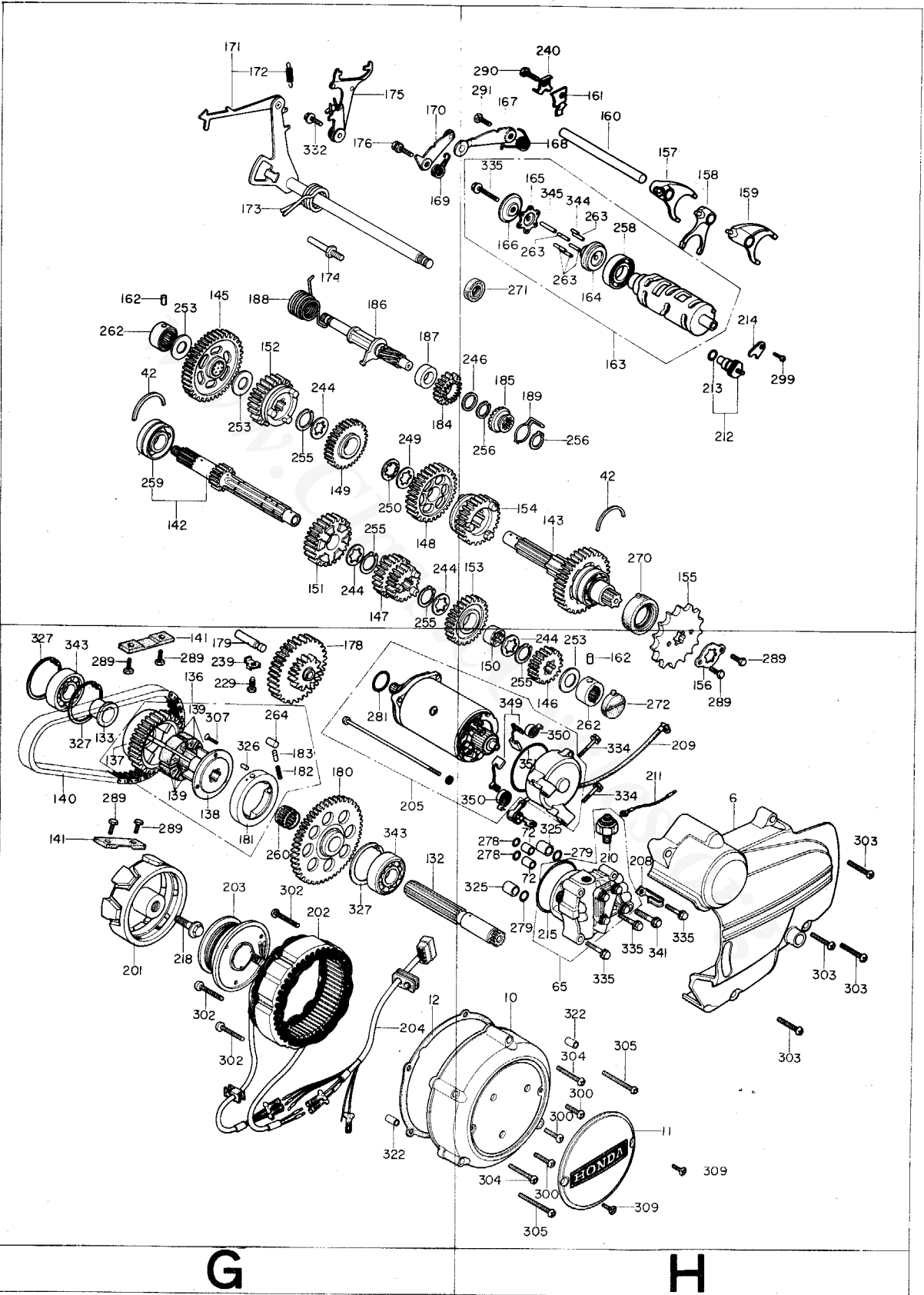

G

H

ENGINE GROUP

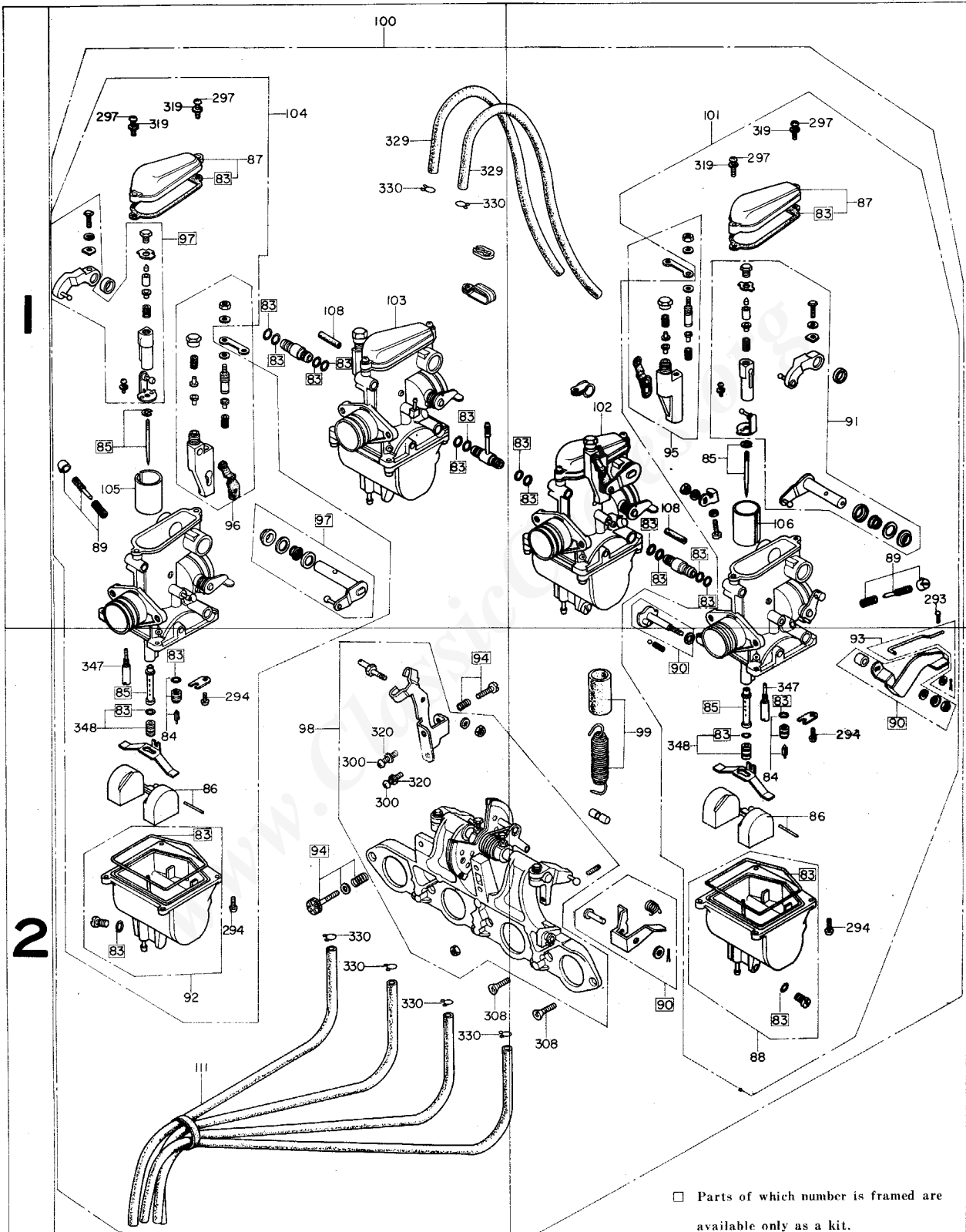

Block No.

| Block No. | Ref. No. | Part No. | Description | Reqd. No. CB400F | Remarks | |
|-----------|----------|----------|---------------|--------------------------------|---------|--|
| | 1F | 1 | 11000-377-000 | CRANKCASE ASSY. | 1 | |
| | 2F | 2 | 11208-333-000 | CAP, OIL PATH | 1 | |
| | 2F | 3 | 11210-377-000 | PAN, OIL | 1 | |
| | 2F | 4 | 11291-333-000 | PLUG, OIL PATH | 1 | |
| ✓ | 1E | 5 | 11331-377-000 | COVER, RIGHT CRANKCASE | 1 | |
| | 2H | 6 | 11341-377-000 | COVER, LEFT CRANKCASE | 1 | |
| | 1E | 7 | 11348-377-000 | COVER, CLUTCH ADJUST | 1 | |
| ✓ | 1E | 8 | 11394-377-000 | PACKING, RIGHT CRANKCASE COVER | 1 | |
| | 2F | 9 | 11398-333-020 | GASKET, OIL PAN | 1 | |
| | 2H | 10 | 11631-377-000 | COVER A, DYNAMO | 1 | |
| | 2H | 11 | 11632-333-010 | COVER B, DYNAMO | 1 | |
| | 2G | 12 | 11691-333-000 | GASKET, DYNAMO COVER | 1 | |
| | 2C | 13 | 12100-377-000 | CYLINDER COMP. | 1 | |
| | 2C | 14 | 12191-377-000 | PACKING, CYLINDER | 1 | |
| | 2C | 15 | 12200-377-000 | HEAD COMP., CYLINDER | 1 | |
| | 2D | 16 | 12202-333-315 | GUIDE, INLET VALVE | 4 | |
| | 1C | 17 | 12203-333-335 | GUIDE, EXHAUST VALVE | 4 | |
| | 2D | 18 | 12209-333-005 | SEAL, VALVE STEM | 4 | |
| ✓ | 2C | 19 | 12251-377-000 | GASKET, CYLINDER HEAD | 28577 1 | |
| | 1C | 20 | 12310-333-020 | COVER, CYLINDER HEAD | 1 | |
| 8 | 1C | 21 | 12320-333-020 | COVER COMP., BREATHER | 1 | |
| | 1C | 22 | 12329-333-010 | GASKET, BREATHER COVER | 1 | |
| | 1C | 23 | 12361-300-000 | CAP, TAPPET ADJUSTING HOLE | 8 | |
| ✓ | 1C | 24 | 12391-333-000 | GASKET, CYLINDER HEAD COVER | 1 | |
| | 1C | 25 | 12431-333-010 | GEAR, TACHOMETER | 1 | |
| | 1C | 26 | 12435-377-000 | COLLAR, TACHOMETER GEAR | 1 | |
| | 2C | 27 | 12901-333-000 | VALVE, OIL CONTROL ORIFICE | 2 | |
| | 1C | 28 | 12903-333-000 | PIPE COMP., RIGHT OIL | 1 | |
| | 1C | 29 | 12904-333-000 | PIPE COMP., LEFT OIL | 1 | |
| | 1C | 30 | 12905-333-000 | HOLDER, OIL PIPE | 2 | |

| Block Ref. No. No. | Part No. | Description | Reqd. No. CB400F | Remarks |
|-----------------------|---------------|---|---------------------|---------|
| 20 31 | 12909-333-000 | GASKET, CYLINDER STUD | 2 | |
| 20 32 | 12910-333-000 | GASKET, ORIFICE VALVE | 2 | |
| 1A 33 | 13011-377-003 | RING SET, PISTON (STD.) (NIPPON) | 4 | |
| | 13011-377-004 | RING SET, PISTON (STD.) (RIKEN) | 4 | |
| | 13011-377-005 | RING SET, PISTON (STD.) (TEIKOKU) | 4 | |
| | 13021-377-003 | RING SET, PISTON (0.25) (OPTIONAL PART) (NIPPON) | 4 | |
| | 13021-377-004 | RING SET, PISTON (0.25) (RIKEN) (OPTIONAL PART) | 4 | |
| | 13021-377-005 | RING SET, PISTON (0.25) (OPTIONAL PART) (TEIKOKU) | 4 | |
| | 13031-377-003 | RING SET, PISTON (0.50) (OPTIONAL PART) (NIPPON) | 4 | |
| | 13031-377-004 | RING SET, PISTON (0.50) (RIKEN) (OPTIONAL PART) | 4 | |
| | 13031-377-005 | RING SET, PISTON (0.50) (OPTIONAL PART) (TEIKOKU) | 4 | |
| | 13041-377-003 | RING SET, PISTON (0.75) (OPTIONAL PART) (NIPPON) | 4 | |
| | 13041-377-004 | RING SET, PISTON (0.75) (RIKEN) (OPTIONAL PART) | 4 | |
| | 13041-377-005 | RING SET, PISTON (0.75) (OPTIONAL PART) (TEIKOKU) | 4 | |
| | 13051-377-003 | RING SET, PISTON (1.00) (OPTIONAL PART) (NIPPON) | 4 | |
| | 13051-377-004 | RING SET, PISTON (1.00) (RIKEN) (OPTIONAL PART) | 4 | |
| | 13051-377-005 | RING SET, PISTON (1.00) (OPTIONAL PART) (TEIKOKU) | 4 | |
| 2A 34 | 13101-377-000 | PISTON (STD.) | 4 | |
| | 13102-377-000 | PISTON (0.25) (OPTIONAL PART) | 4 | |
| | 13103-377-000 | PISTON (0.50) (OPTIONAL PART) | 4 | |
| | 13104-377-000 | PISTON (0.75) (OPTIONAL PART) | 4 | |
| | 13105-377-000 | PISTON (1.00) (OPTIONAL PART) | 4 | |
| 2A 35 | 13111-087-000 | PIN, PISTON | 4 | |

| Block No. | Ref. No. | Part No. | Description | Reqd. No. CB400F | Remarks |
|-----------|----------|---------------|---|------------------|---------|
| 2A | 36 | 13210-333-002 | ROD COMP.B, CONNECTING 13210-333-003 | 4 | |
| | | 13210-333-003 | ROD COMP.C, CONNECTING | 4 | |
| | | 13210-333-004 | ROD COMP.D, CONNECTING | 4 | |
| | | 13210-333-005 | ROD COMP.E, CONNECTING 13210-333-004 | 4 | |
| 2A | 37 | 13213-333-003 | BOLT, CONNECTING ROD (TOKAI) | 8 | |
| 2A | 38 | 13214-300-000 | NUT, CONNECTING ROD | 8 | |
| 2A | 39 | 13215-333-003 | BEARING A, CONNECTING ROD (DAIDO) | 8 | |
| | | 13216-333-003 | BEARING B, CONNECTING ROD (DAIDO) | 8 | |
| | | 13217-333-003 | BEARING C, CONNECTING ROD (DAIDO) | 8 | |
| | | 13218-333-003 | BEARING D, CONNECTING ROD (DAIDO) | 8 | |
| | | 13219-333-003 | BEARING E, CONNECTING ROD (DAIDO) | 8 | |

Selection table of connecting rod big end bearing

| Crank pin allowance | | Connecting rod allowance | | | | | |
|---------------------|---|--------------------------|-------------------------------------|----------------------|---|----------------------|---|
| | | A | 32φ ⁺⁰ _{-0.010} | B | 32φ ^{-0.010} _{-0.020} | C | 32φ ^{-0.020} _{-0.030} |
| | | Bearing mark (color) | Clearance (μ) | Bearing mark (color) | Clearance (μ) | Bearing mark (color) | Clearance (μ) |
| 1 | 35φ ^{+0.008} ₋₀ | E (RED) | 18~44 | D (YELLOW) | 20~46 | C (GREEN) | 22~48 |
| 2 | 35φ ^{+0.015} _{+0.008} | D (YELLOW) | 18~44 | C (GREEN) | 20~46 | B (BROWN) | 22~48 |
| 3 | 35φ ^{+0.024} _{+0.016} | C (GREEN) | 18~44 | B (BROWN) | 20~46 | A (BLACK) | 22~48 |

| | | | | | |
|----|----|---------------|-------------------------------|----|--|
| 2B | 40 | 13300-333-010 | CRANKSHAFT COMP. | 1 | |
| 2A | 41 | 13314-333-003 | BEARING A, CRANKSHAFT (DAIDO) | 10 | |
| | | 13315-333-003 | BEARING A, CRANKSHAFT (DAIDO) | 10 | |
| | | 13316-333-003 | BEARING B, CRANKSHAFT (DAIDO) | 10 | |
| | | 13317-333-003 | BEARING C, CRANKSHAFT (DAIDO) | 10 | |
| | | 13318-333-003 | BEARING D, CRANKSHAFT (DAIDO) | 10 | |
| | | 13319-333-003 | BEARING E, CRANKSHAFT (DAIDO) | 10 | |

Selection table of crankshaft journal main bearing

| Crankshaft journal allowance | | Crankcase allowance | | | | | |
|------------------------------|---|----------------------|-------------------------------------|----------------------|---|----------------------|---|
| | | 1 | 32φ ⁺⁰ _{-0.010} | 2 | 32φ ^{-0.010} _{-0.020} | 3 | 32φ ^{-0.020} _{-0.030} |
| | | Bearing mark (color) | Clearance (μ) | Bearing mark (color) | Clearance (μ) | Bearing mark (color) | Clearance (μ) |
| A | 35φ ^{+0.008} ₋₀ | D (YELLOW) | 20~46 | C (GREEN) | 22~48 | B (BROWN) | 24~50 |
| B | 35φ ^{+0.015} _{+0.008} | C (GREEN) | 20~46 | B (BROWN) | 22~48 | A (BLACK) | 24~50 |
| C | 35φ ^{+0.024} _{+0.016} | B (BROWN) | 20~46 | A (BLACK) | 22~48 | AA (BLUE) | 24~50 |

| | | | | | |
|----|----|---------------|-------------------------|---|--|
| 1G | 42 | 13492-283-000 | RING, BEARING SET, 52MM | 2 | |
| 1B | 43 | 14101-333-020 | CAMSHAFT | 1 | |
| 1B | 44 | 14321-377-000 | SPROCKET, CAM (32T) | 1 | |
| 1B | 45 | 14401-333-003 | CHAIN, CAM | 1 | |

| Block No. | Ref. No. | Part No. | Description | Reqd. No. CB400F | Remarks |
|-----------|----------|---------------|--|---------------------|---------|
| 1A | 46 | 14431-333-000 | ARM, VALVE ROCKER | 8 | |
| 1A | 47 | 14435-333-000 | SPRING, ROCKER ARM SIDE | 8 | |
| 1A | 48 | 14451-333-000 | SHAFT, VALVE ROCKER ARM | 4 | |
| 2B | 49 | 14500-333-020 | ARM COMP., CAM CHAIN TENSIONER | 1 | |
| 1B | 50 | 14501-323-000 | DAMPER, CAM CHAIN TENSIONER | 2 | |
| 1B | 51 | 14530-333-000 | HOLDER COMP., CAM CHAIN TENSIONER | 1 | |
| 1A | 52 | 14541-333-020 | SPRING, CAM CHAIN TENSIONER OUTER | 1 | |
| 1A | 53 | 14543-333-000 | SPRING, CAM CHAIN TENSIONER INNER | 1 | |
| 1B | 54 | 14545-333-000 | SLIPPER, CAM CHAIN TENSIONER | 1 | |
| 1A | 55 | 14550-333-000 | BAR COMP., CAM CHAIN TENSIONER PUSH | 1 | |
| 1A | 56 | 14620-333-000 | GUIDE, CAM CHAIN | 1 | |
| 1B | 57 | 14711-377-000 | VALVE, INLET | 4 | |
| 1A | 58 | 14721-377-000 | VALVE, EXHAUST | 4 | |
| 1A | 59 | 14751-333-010 | SPRING, VALVE (OUTER) | 8 | |
| 1A | 60 | 14761-333-010 | SPRING, VALVE (INNER) | 8 | |
| 1A | 61 | 14771-107-020 | RETAINER, VALVE SPRING | 8 | |
| 1A | 62 | 14775-107-000 | SEAT, VALVE SPRING OUTER | 8 | |
| 1A | 63 | 14776-107-010 | SEAT, VALVE SPRING INNER | 8 | |
| 1A | 64 | 14781-107-020 | COTTER, VALVE | 16 | |
| 2H | 65 | 15100-333-010 | PUMP ASSY., OIL | 1 | |
| 2F | 66 | 15151-333-000 | SCREEN, OIL STRAINER | 1 | |
| 2F | 67 | 15152-333-000 | PLATE, OIL SEPALATOR | 1 | |
| 2F | 68 | 15153-333-000 | BODY, OIL SCREEN | 1 | |
| 2F | 69 | 15155-333-000 | PIPE, MISSION OIL | 1 | |
| 2F | 70 | 15157-333-000 | SPRING, OIL SCREEN SETTING | 1 | |
| 2F | 71 | 15332-300-000 | CAP B, OIL PATH | 1 | |
| 2H | 72 | 15391-333-000 | COLLAR, O-RING GUIDE | 2 | |
| 2E | 73 | 15411-300-010 | CASE, OIL FILTER | 1 | |
| 2E | 74 | 15412-300-024 | ELEMENT, OIL FILTER (TOKYO ROKI) | 1 | |
| 2E | 75 | 15414-300-000 | SEAT, OIL FILTER SPRING | 1 | |

| Block No. | Ref. No. | Part No. | Description | Reqd. No. CB400F | Remarks |
|-----------|----------|---------------|--------------------------------|---------------------|---------|
| 2E | 76 | 15415-300-000 | SPRING, OIL FILTER ELEMENT SET | 1 | |
| 2E | 77 | 15420-300-020 | BOLT COMP., OIL FILTER CENTER | 1 | |
| 2E | 78 | 15473-300-300 | VALVE, CHECK | 1 | |
| 2E | 79 | 15474-300-310 | SPRING, CHECK VALVE | 1 | |
| 2E | 80 | 15477-300-300 | PIN, SPRING SET | 1 | |
| 1E | 81 | 15650-333-000 | GAUGE, OIL LEVEL | 1 | |
| 1D | 82 | 15772-292-010 | CLIP, BREATHER TUBE | 1 | |
| 1J | 83 | 16010-333-004 | GASKET SET | 4 | |
| 2J | 84 | 16011-329-004 | VALVE SET, FLOAT | 4 | |
| 1J | 85 | 16012-377-004 | NEEDLE SET, JET (KEIHIN) | 4 | |
| 2J | 86 | 16013-333-004 | FLOAT SET | 4 | |
| 1J | 87 | 16014-333-004 | TOP SET | 4 | |
| 2K | 88 | 16015-333-004 | CHAMBER SET A, FLOAT | 2 | |
| 1J | 89 | 16016-377-004 | SCREW SET A (KEIHIN) | 4 | |
| 2K | 90 | 16017-333-004 | LINK SET | 1 | |
| 1K | 91 | 16018-333-004 | ARM SET, LINK | 2 | |
| 2J | 92 | 16023-333-004 | CHAMBER SET B, FLOAT | 2 | |
| 2K | 93 | 16025-333-004 | ROD SET, CHOKE | 1 | |
| 2J | 94 | 16028-333-004 | SCREW SET B | 1 | |
| 1K | 95 | 16029-323-004 | HOLDER SET A, ADJUST | 2 | |
| 1J | 96 | 16030-323-004 | HOLDER SET B, ADJUST | 2 | |
| 1J | 97 | 16031-333-004 | ARM SET B, LINK | 2 | |
| 2J | 98 | 16035-333-004 | PLATE SET, STAY | 1 | |
| 2K | 99 | 16036-323-004 | TUBE SET, PROTECT | 1 | |
| 1J | 100 | 16100-377-004 | CARBURETOR ASSY. (KEIHIN) | 1 | |
| 1K | 101 | 16101-377-004 | CARBURETOR ASSY. 1 (KEIHIN) | 1 | |
| 1K | 102 | 16102-377-004 | CARBURETOR ASSY. 2 (KEIHIN) | 1 | |
| 1J | 103 | 16103-377-004 | CARBURETOR ASSY. 3 (KEIHIN) | 1 | |
| 1J | 104 | 16104-377-004 | CARBURETOR ASSY. 4 (KEIHIN) | 1 | |
| 1J | 105 | 16111-333-004 | VALVE A, THROTTLE | 2 | |

ENGINE GROUP

REF.NO. 106~135

| Block No. | Ref. No. | Part No. | Description | Reqd. No. CB400F | Remarks |
|-----------|----------|---------------|-------------------------------|---------------------|---------|
| 1K | 106 | 16112-333-004 | VALVE B, THROTTLE | 2 | |
| 1D | 107 | 16173-253-004 | O-RING, 27X2.4 | 4 | |
| 1J | 108 | 16199-333-004 | TUBE, FUEL, 2.5X16 | 2 | |
| 1D | 109 | 16212-333-030 | INSULATOR A, CARBURETOR | 2 | |
| 1D | 110 | 16213-333-030 | INSULATOR B, CARBURETOR | 2 | |
| 2J | 111 | 16290-333-000 | TUBE, OVER FLOW | 1 | |
| 1D | 112 | 17255-246-000 | BAND, CLEANER CONNECTING TUBE | 4 | |
| 2E | 113 | 22100-377-000 | OUTER COMP., CLUTCH | 1 | |
| 2E | 114 | 22116-333-020 | COLLAR, 25MM | 1 | |
| 1E | 115 | 22120-377-000 | CENTER COMP., CLUTCH | 1 | |
| 1E | 116 | 22125-333-000 | SEAT, DISK SPRING | 1 | |
| 1E | 117 | 22201-302-000 | DISK, CLUTCH FRICTION | 1 | |
| 2E | 118 | 22201-377-000 | DISK, CLUTCH FRICTION | 6 | |
| 1E | 119 | 22321-333-010 | PLATE B, CLUTCH | 1 | |
| 2E | 120 | 22350-333-010 | PLATE, CLUTCH PRESSURE | 1 | |
| 1E | 121 | 22361-377-000 | PLATE, CLUTCH LIFTER | 1 | |
| 1E | 122 | 22401-369-000 | SPRING, CLUTCH | 4 | |
| 1E | 123 | 22402-333-003 | DISK, CLUTCH SPRING | 1 | |
| 1E | 124 | 22810-377-000 | LEVER COMP., CLUTCH | 1 | |
| 1E | 125 | 22815-300-000 | SPRING, CLUTCH LEVER | 1 | |
| 1E | 126 | 22818-354-000 | BOLT, ADJUST, A10X44 | 1 | |
| 1F | 127 | 22820-300-000 | SHAFT, CLUTCH RELIESE | 1 | |
| 1E | 128 | 22830-300-000 | CAM COMP., CLUTCH LIFTER | 1 | |
| 1F | 129 | 22841-300-000 | BOLT, CLUTCH ADJUSTING | 1 | |
| 1E | 130 | 22846-300-000 | PIECE, CLUTCH LIFTER | 1 | |
| 1E | 131 | 22860-300-006 | RETAINER COMP., CLUTCH BALL | 1 | |
| 2G | 132 | 23101-377-000 | SHAFT, PRIMARY | 1 | |
| 2G | 133 | 23102-377-000 | COLLAR, 25X31.8 | 1 | |
| 2E | 134 | 23104-377-000 | COLLAR, 25X16.5 | 1 | |
| 2E | 135 | 23108-333-020 | GEAR, SECONDARY DRIVE (23T) | 1 | |

| Block No. | Ref. No. | Part No. | Description | Reqd. No. CB400F | Remarks |
|-----------|----------|---------------|--|---------------------|---------|
| 2G | 136 | 23110-377-000 | SPROCKET COMP., PRIMARY DRIVEN | 1 | |
| 2G | 137 | 23111-333-000 | SPROCKET, PRIMARY DRIVEN | 1 | |
| 2G | 138 | 23112-333-000 | HUB, DRIVEN SPROCKET | 1 | |
| 2G | 139 | 23114-323-000 | RUBBER, GAMPER | 8 | |
| 2G | 140 | 23131-323-000 | CHAIN, PRIMARY DRIVE | 1 | |
| 2G | 141 | 23132-333-010 | GUIDE, PRIMARY CHAIN | 2 | |
| 1G | 142 | 23210-377-000 | MAINSHAFT COMP. (24T) | 1 | |
| 1H | 143 | 23220-377-000 | COUNTERSHAFT COMP. (36T) | 1 | |
| 2E | 144 | 23311-200-000 | PLATE A, CLUTCH | 6 | |
| 1G | 145 | 23420-377-000 | GEAR COMP., COUNTERSHAFT 1 ST (41T) | 1 | |
| 2H | 146 | 23431-369-000 | GEAR, MAIN SHAFT SECOND (20T) | 1 | |
| 1G | 147 | 23451-369-000 | GEAR, MAIN SHAFT THIRD FOURTH (24T, 27T) | 1 | |
| 1G | 148 | 23461-377-010 | GEAR, COUNTERSHAFT THIRD (33T) | 1 | |
| 1G | 149 | 23481-377-010 | GEAR, COUNTERSHAFT FOURTH (30T) | 1 | |
| 2H | 150 | 23485-369-000 | BUSH, SPLINE, 28MM | 1 | |
| 1G | 151 | 23491-369-000 | GEAR, MAIN SHAFT FIFTH (29T) | 1 | |
| 1G | 152 | 23501-377-010 | GEAR, COUNTERSHAFT FIFTH (28T) | 1 | |
| 1H | 153 | 23511-377-000 | GEAR, MAINSHAFT TOP (30T) | 1 | |
| 1H | 154 | 23521-377-010 | GEAR, COUNTERSHAFT TOP (26T) | 1 | |
| 1H | 155 | 23801-333-000 | SPROCKET, DRIVE (17T) | 1 | |
| 2H | 156 | 23811-292-000 | PLATE, DRIVE SPROCKET FIXING | 1 | |
| 1H | 157 | 24211-377-010 | FORK, RIGHT GEAR SHIFT | 1 | |
| 1H | 158 | 24216-333-020 | FORK, CENTER GEAR SHIFT | 1 | |
| 1H | 159 | 24221-377-000 | FORK, LEFT GEAR SHIFT | 1 | |
| 1H | 160 | 24226-377-000 | SHAFT, SHIFT FORK GUIDE | 1 | |
| 1H | 161 | 24231-333-010 | PLATE, GUIDE SHAFT SFT | 1 | |
| 1G | 162 | 24261-283-000 | PIN, GEAR SHIFT FORK GUIDE | 2 | |
| 1H | 163 | 24300-377-000 | DRUM ASSY., GEAR SHIFT | 1 | |
| 1H | 164 | 24304-377-000 | CENTER, GEAR SHIFT DRUM | 1 | |
| 1H | 165 | 24321-377-000 | PLATE, DRUM STOPPER | 1 | |

ENGINE GROUP

REF.NO. 166~190

| Block No. | Ref. No. | Part No. | Description | Repl. No. CB400F | Remarks |
|-----------|----------|---------------|---------------------------------------|---------------------|---------|
| 1H | 166 | 24326-300-000 | PLATE, GEAR SHIFT SIDE | 1 | |
| 1H | 167 | 24430-377-000 | STOPPER COMP., GEAR SHIFT DRUM | 1 | |
| 1H | 168 | 24435-333-000 | SPRING, SHIFT DRUM STOPPER | 1 | |
| 1G | 169 | 24436-333-010 | SPRING, NEUTRAL STOPPER | 1 | |
| 1G | 170 | 24440-333-000 | ARM COMP., NEUTRAL STOPPER | 1 | |
| 1G | 171 | 24610-377-000 | SPINDLE COMP., GEAR SHIFT | 1 | |
| 1G | 172 | 24641-216-000 | SPRING, GEAR SHIFT ARM | 1 | |
| 1G | 173 | 24651-333-000 | SPRING, GEAR SHIFT RETURN | 1 | |
| 1G | 174 | 24652-035-000 | PIN, SHIFT RETURN SPRING | 1 | |
| 1G | 175 | 24660-377-000 | STOPPER COMP., POSITIVE | 1 | |
| 1G | 176 | 24667-333-020 | PIN, RETURN SPRING, 6 MM | 1 | |
| 1A | 177 | 25911-500-000 | BOLT, OIL CHECK | 1 | |
| 2G | 178 | 28101-377-000 | GEAR, STARTER REDUCTION | 1 | |
| 2G | 179 | 28106-333-000 | SHAFT, STARTER REDUCTION GEAR | 1 | |
| 2G | 180 | 28111-333-310 | GEAR, STARTING CLUTCH | 1 | |
| 2G | 181 | 28120-377-000 | OUTER, STARTING CLUTCH | 1 | |
| 2G | 182 | 28125-253-020 | SPRING, STARTING CLUTCH ROLLER | 3 | |
| 2G | 183 | 28126-253-030 | CAP, STARTING CLUTCH ROLLER SPRING | 3 | |
| 1G | 184 | 28211-333-020 | PINION, KICK STARTER | 1 | |
| 1H | 185 | 28221-333-010 | RATCHET, KICK STARTER | 1 | |
| 1G | 186 | 28251-333-010 | SPINDLE, KICK STARTER | 1 | |
| 1G | 187 | 28259-333-010 | COLLAR, KICK SPINDLE | 1 | |
| 1G | 188 | 28261-333-030 | SPRING, KICK STARTER | 1 | |
| 1H | 189 | 28271-333-000 | SPRING, STARTER PINION FRICTION | 1 | |
| 2B | 190 | 30200-323-154 | BREAKER ASSY., CONTACT (TOYO) | 1 | |
| | | 30200-333-004 | BREAKER ASSY., CONTACT (ND) | 1 | |

| Block Ref. No. No. | Part No. | Description | Reqd. No. CB400F | Remarks |
|-----------------------|---------------|-------------------------------------|---------------------|---------|
| 2E 191 | 30201-300-154 | PLATE, CONTACT BREAKER BASE | 1 | |
| | 30201-333-004 | PLATE, CONTACT BREAKER BASE (ND) | 1 | |
| 2E 192 | 30204-300-154 | BREAKER, 283 CYLINDER CONTACT | 1 | |
| | 30203-333-004 | BREAKER, RIGHT CONTACT (ND) | 1 | |
| 2E 193 | 30203-300-154 | BREAKER, 184 CYLINDER CONTACT | 1 | |
| | 30204-333-004 | BREAKER, LEFT CONTACT (ND) | 1 | |
| 2E 194 | 30205-300-154 | FELT, OIL (TOYO) | 1 | |
| | 30205-333-004 | FELT, OIL (ND) | 1 | |
| 2E 195 | 30215-300-154 | PLATE, SHIFT BRAKER | 1 | |
| | 30215-333-004 | PLATE, BREAKER SHIFT (ND) | 1 | |
| 2E 196 | 30220-333-004 | ADVANCER ASSY., SPARK (ND) | 1 | |
| | 30220-377-154 | ADVANCER, SPARK (TOYO) | 1 | |
| 2E 197 | 30233-333-000 | WASHER, ADVANCER SPECIAL | 1 | |
| 2E 198 | 30250-333-004 | CONDENSER COMP. | 2 | |
| 2E 199 | 30370-323-000 | COVER COMP., POINT | 1 | |
| 2E 200 | 30372-300-300 | GASKET, POINT COVER | 1 | |
| 2G 201 | 31101-333-004 | ROTOR COMP. (ND) | 1 | |
| 2G 202 | 31102-333-004 | STATOR COMP. (ND) | 1 | |
| 2G 203 | 31103-333-004 | COIL COMP., FIELD (ND) | 1 | |
| 2G 204 | 31110-333-000 | HARNES, A.C. GENERATOR WIRE | 1 | |
| 2G 205 | 31200-333-000 | MOTOR ASSY., STARTING | 1 | |
| 1F 206 | 32111-333-000 | CLAMPER A, CORD | 1 | |
| 1E 207 | 32112-333-000 | CLAMPER B, CORD | 2 | |
| 2H 208 | 32113-333-000 | CLAMPER C, CORD | 1 | |
| 2H 209 | 32410-333-000 | CABLE, STARTING MOTOR | 1 | |
| 2H 210 | 35500-333-014 | SWITCH ASSY., OIL PRESSURE (ND) | 1 | |
| 2H 211 | 35510-333-000 | CORD, PRESSURE SUB | 1 | |
| 1H 212 | 35750-333-023 | SWITCH, NEUTRAL (TOYO) | 1 | |
| 1H 213 | 35751-333-003 | O-RING | 1 | |
| 1H 214 | 35755-333-010 | PLATE, NEUTRAL SWITCH FIXING | 1 | |
| 2H 215 | 41123-516-000 | O-RING, 63X2.5 | 1 | |

| Block No. | Ref. No. | Part No. | Description | Reqd. No. CB400F | Remarks |
|-----------|----------|---------------|----------------------------|------------------|---------|
| 1A | 216 | 90012-333-000 | SCREW, TAPPET ADJUSTING | 8 | |
| 2B | 217 | 90013-333-010 | BOLT, U.B.S., 12X30 | 1 | |
| 2G | 218 | 90014-333-000 | BOLT, HEX., 10X32 | 1 | |
| 2A | 219 | 90016-286-000 | BOLT, TENSIONER SETTING | 1 | |
| 1F | 220 | 90017-333-000 | BOLT, FLANGE, 8X60 | 5 | |
| 1G | 221 | 90018-333-000 | BOLT, U.B.S., 6X38 | 2 | |
| 1F | 222 | 90031-377-000 | STUD A, CYLINDER, 8X154 | 8 | |
| 1F | 223 | 90032-377-000 | STUD B, CYLINDER, 8X122 | 2 | |
| 1F | 224 | 90033-377-000 | STUD C, CYLINDER, 10X139 | 2 | |
| 1G | 225 | 90044-377-000 | BOLT, STUD, 6X47 | 8 | |
| 2F | 226 | 90045-329-000 | BOLT, U.B.S., 8X114 | 6 | |
| 1B | 227 | 90081-246-000 | BOLT, HEX., KNOCK, 7X12 | 2 | |
| 1B | 228 | 90081-312-000 | BOLT, KNOCK, 6X14 | 2 | |
| 2G | 229 | 90081-512-010 | BOLT, STOPPER, 6MM | 1 | |
| 1A | 230 | 90084-333-000 | BOLT, SEALING | 4 | |
| 2F | 231 | 90086-333-000 | BOLT, U.B.S., 8X97 | 4 | |
| 2E | 232 | 90201-333-020 | WASHER, PRIMARY SHAFT LOCK | 1 | |
| 1A | 233 | 90206-001-000 | NUT, TAPPET ADJUSTING | 8 | |
| 1E | 234 | 90231-200-010 | NUT, LOCK, 16MM | 1 | |
| 1G | 235 | 90236-300-000 | NUT, 8MM | 2 | |
| 1C | 236 | 90237-333-000 | NUT, SPECIAL, 8MM | 2 | |
| 1E | 237 | 90402-822-000 | WASHER, HEAD, 8MM | 1 | |
| 1E | 238 | 90431-292-000 | WASHER, LOCK, 16MM | 1 | |
| 2G | 239 | 90433-283-000 | WASHER, LOCK, 6MM | 1 | |
| 1H | 240 | 90435-333-000 | WASHER, TONGUED, 8 MM | 1 | |
| 1G | 241 | 90441-377-000 | WASHER, SEALING, 8MM | 10 | |
| 1G | 242 | 90442-377-000 | WASHER, SEAL | 2 | |
| 1G | 243 | 90443-107-000 | NUT, HEX., CAP, 8MM | 8 | |
| 1G | 244 | 90451-300-000 | WASHER, THRUST, 25MM | 4 | |
| 1G | 245 | 90452-323-000 | WASHER, THRUST, 5MM | 4 | |
| 1H | 246 | 90454-107-000 | WASHER B, THRUST, 20 MM | 1 | |
| 2F | 247 | 90455-333-010 | WASHER, THRUST, 25MM | 1 | |
| 1G | 248 | 90458-324-010 | WASHER, THRUST, 6.7MM | 1 | |
| 1G | 249 | 90461-286-000 | WASHER B, THRUST, 25MM | 1 | |
| 1G | 250 | 90462-323-000 | WASHER, LOCK, 25MM | 1 | |

| Block No. | Ref. No. | Part No. | Description | Reqd. No. CB400F | Remarks |
|-----------|----------|---------------|-------------------------------|---------------------|---------|
| 1A | 251 | 90474-333-000 | WASHER, 8MM | 1 | |
| 1E | 252 | 90481-292-000 | WASHER, OIL FILTER ROTOR LOCK | 1 | |
| 1G | 253 | 90554-700-000 | WASHER, THRUST, 20MM | 3 | |
| 1C | 254 | 90601-333-000 | SET RING, 12.7MM | 1 | |
| 1G | 255 | 90602-259-010 | CIR CLIP, 25MM | 4 | |
| 1H | 256 | 90605-200-000 | SET RING, 20MM | 2 | |
| 1E | 257 | 90609-333-000 | SET RING, SPECIAL, 92MM | 1 | |
| 1H | 258 | 91001-235-300 | BEARING, RADIAL BALL, 16004 | 1 | |
| 1G | 259 | 91002-286-008 | BEARING, BALL, 5205HS (TOYO) | 1 | |
| 2G | 260 | 91007-323-000 | BEARING, NEEDLE, 25X29X17 | 1 | |
| 1E | 261 | 91008-362-000 | BEARING, RADIAL BALL, 16003 | 1 | |
| 1G | 262 | 91022-377-008 | BEARING, NEEDLE, 20MM | 2 | |
| 1H | 263 | 91101-333-000 | ROLLER, 4X16.8 | 5 | |
| 2A | 264 | 91101-377-000 | ROLLER, 10.2X11.5 | 3 | |
| 2A | 265 | 91201-300-003 | OIL SEAL, 30X42X8 | 1 | |
| 2B | 266 | 91201-323-005 | OIL SEAL, 30X45X8 | 1 | |
| 1C | 267 | 91201-324-010 | OIL SEAL, 6.5X14.5X7 | 1 | |
| 1E | 268 | 91202-216-005 | OIL SEAL, 14X24X5 | 1 | |
| 1E | 269 | 91204-259-000 | OIL SEAL, 16X28X7 | 1 | |
| 1H | 270 | 91205-333-005 | OIL SEAL, 34X52X13.5X15.5 | 1 | |
| 1H | 271 | 91206-286-005 | OIL SEAL, 14X28X7 | 1 | |
| | | 91206-286-013 | OIL SEAL, 14X28X7 | 1 | |
| 2H | 272 | 91207-333-000 | OIL SEAL, 34X9 | 1 | |
| 1C | 273 | 91301-200-000 | O-RING, 10X1.6 | 8 | |
| 1F | 274 | 91301-283-005 | O-RING, 5X2.4 | 1 | |
| 1C | 275 | 91301-333-000 | O-RING, 7X1.7 | 1 | |
| 2C | 276 | 91301-377-000 | O-RING, 55.5X2 | 4 | |
| 1C | 277 | 91302-001-020 | O-RING, 30.8MM | 8 | |
| 2H | 278 | 91302-044-010 | O-RING, 6.9X1.5 | 2 | |
| 2E | 279 | 91302-377-000 | O-RING, 15X2.5 | 3 | |
| 2D | 280 | 91305-333-000 | O-RING, 5X1.7 | 1 | |

| Block Ref. No. | Part No. | Description | Reqd. No. CB400F | Remarks |
|----------------|----------------|------------------------|------------------|---------|
| 2G 281 | 91309-300-000 | O-RING, 24.4X3.1 | 1 | |
| 2F 282 | 91314-220-000 | O-RING, 16.4X2.4 | 1 | |
| 2F 283 | 91315-044-000 | O-RING, 19.4X2.8 | 1 | |
| 2E 284 | 91316-300-003 | O-RING, 89X4.5 | 1 | |
| 2A 285 | 91317-703-000 | O-RING, 6X1.7 | 1 | |
| 2F 286 | 91319-300-000 | O-RING, 13X2.5 | 1 | |
| 2F 287 | 91329-590-003 | O-RING, 16.5X2 | 1 | |
| 1E 288 | 91354-702-000 | O-RING, 23MM | 1 | |
| 2G 289 | 92000-06012 | BOLT, HEX., 6X12 | 6 | |
| 1H 290 | 92000-08020-0A | BOLT, HEX., 8X20 | 1 | |
| 1H 291 | 92100-06020 | BOLT, HEX., 6X20 | 1 | |
| 2F 292 | 92800-12000 | BOLT, DRAIN PLUG, 12MM | 1 | |
| 1K 293 | 93500-03006-0A | SCREW, PAN, 3X6 | 1 | |
| 2J 294 | 93500-04010-0A | SCREW, PAN, 4X10 | 20 | |
| 1G 295 | 93500-05006-0A | SCREW, PAN, 5X6 | 4 | |
| 2E 296 | 93500-05014-0A | SCREW, PAN, 5X14 | 3 | |
| 1J 297 | 93500-05016-0A | SCREW, PAN, 5X16 | 8 | |
| 1D 298 | 93500-05025-0A | SCREW, PAN, 5X25 | 4 | |
| 2F 299 | 93500-06012 | SCREW, PAN, 6X12 | 5 | |
| 2H 300 | 93500-06016 | SCREW, PAN, 6X16 | 5 | |
| 1D 301 | 93500-06018 | SCREW, PAN, 6X18 | 8 | |
| 2G 302 | 93500-06032 | SCREW, PAN, 6X32 | 3 | |
| 1E 303 | 93500-06035 | SCREW, PAN, 6X35 | 5 | |
| 1E 304 | 93500-06040 | SCREW, PAN, 6X40 | 9 | |
| 2H 305 | 93500-06055 | SCREW, PAN, 6X55 | 2 | |
| 1E 306 | 93500-06060 | SCREW, PAN, 6X60 | 2 | |
| 2G 307 | 93600-06014 | SCREW, FLAT, 6X14 | 3 | |
| 2J 308 | 93600-06016 | SCREW, FLAT, 6X16 | 8 | |
| 2H 309 | 93700-04012-0B | SCREW, OVAL, 4X12 | 2 | |
| 1G 310 | 93700-05020-0A | SCREW, OVAL, 5X20 | 1 | |

| Block Ref. No. No. | Part No. | Description | Reqd. No. CB400F | Remarks |
|-----------------------|----------------|--------------------------|---------------------|---------|
| 1E 311 | 93700-06016 | SCREW, OVAL, 6X16 | 2 | |
| 2E 312 | 93700-06030 | SCREW, OVAL, 6X30 | 2 | |
| 1E 313 | 94001-10000-0S | NUT, HEX., 10MM | 1 | |
| 2A 314 | 94002-08000-0S | NUT, HEX., 8MM | 2 | |
| 2E 315 | 94101-05000 | WASHER, PLAIN, 5MM | 3 | |
| 2A 316 | 94101-06000 | WASHER, PLAIN, 6MM | 1 | |
| 2F 317 | 94109-12000 | WASHER, DRAIN PLUG, 12MM | 1 | |
| 1A 318 | 94109-14000 | WASHER, DRAIN PLUG, 14MM | 4 | |
| 1J 319 | 94111-05000 | WASHER, SPRING, 5MM | 8 | |
| 2J 320 | 94111-06000 | WASHER, SPRING, 6MM | 2 | |
| 1F 321 | 94301-08100 | PIN A, DOWEL, 8X10 | 2 | |
| 1C 322 | 94301-08140 | PIN A, DOWEL, 8X14 | 8 | |
| 1F 323 | 94301-10140 | PIN A, DOWEL, 10X14 | 2 | |
| 2C 324 | 94301-12200 | PIN A, DOWEL, 12X20 | 4 | |
| 2H 325 | 94301-14200 | PIN A, DOWEL, 14X20 | 2 | |
| 2G 326 | 94302-06100 | PIN, KNOCK, 6X10E | 1 | |
| 2G 327 | 94520-52000 | CIR CLIP, INTERNAL, 52MM | 3 | |
| 1A 328 | 94601-13000 | CLIP, PISTON PIN, 13MM | 8 | |
| 1J 329 | 95001-35600-40 | TUBE, FUEL, 3.5X600 | 2 | |
| 1J 330 | 95002-02070 | CLIP, TUBE, B7 | 6 | |
| 1D 331 | 95005-11470-30 | TUBE, 11X470 | 1 | |
| 1B 332 | 95700-06016 | BOLT, FLANGE, 6X16 | 3 | |
| 1E 333 | 95700-06020 | BOLT, FLANGE, 6X20 | 4 | |
| 1C 334 | 95700-06028 | BOLT, FLANGE, 6X28 | 11 | |
| 1C 335 | 95700-06032 | BOLT, FLANGE, 6X32 | 10 | |
| 1C 336 | 95700-06035 | BOLT, FLANGE, 6X35 | 2 | |
| 1C 337 | 95700-06040 | BOLT, FLANGE, 6X40 | 19 | |
| 1C 338 | 95700-06060 | BOLT, FLANGE, 6X60 | 8 | |
| 1F 339 | 95700-06090 | BOLT, FLANGE, 6X90 | 3 | |
| 1F 340 | 95700-06100 | BOLT, FLANGE, 6X100 | 1 | |

ENGINE GROUP

REF.NO. 341~351

| Block No. | Ref. No. | Part No. | Description | Reqd. No. CB400F | Remarks |
|-----------|----------|----------------|--|------------------|---------|
| 2H | 341 | 95700-08032 | BOLT, FLANGE, 8X32 | 1 | |
| 2E | 342 | 95800-06055 | BOLT, FLANGE, 6X55 | 1 | |
| 2G | 343 | 96100-62050 | BEARING, RADIAL BALL, 6205 | 2 | |
| 1H | 344 | 96220-40118 | ROLLER, 4X11.8 | 1 | |
| 1H | 345 | 96220-40218 | ROLLER, 4X21.8 | 1 | |
| 2D | 346 | 98069-38710 | PLUG, SPARK (D-8ES-L NGK) | 4 | |
| 2J | 347 | 99124-076-0380 | JET, SLOW (#38) (OPTIONAL PART) | 4 | |
| | | 99124-076-0400 | JET SLOW #40 (STD.) | 4 | |
| | | 99124-076-0420 | JET SLOW #42 (OPTIONAL PART) | 4 | |
| 2J | 348 | 99202-601-0720 | JET SET, MAIN (#72) (OPTIONAL PART) | 4 | |
| | | 99202-601-0750 | JET SET, MAIN (#75) (STD.) | 4 | |
| | | 99202-601-0780 | JET SET, MAIN (#78) (OPTIONAL PART) | 4 | |
| 2H | 349 | 31201-230-174 | BRUSH SET, CARBON (MITSUBA) | 1 | |
| 2H | 350 | 31204-225-154 | SPRING, CARBON BRUSH (MITSUBA) | 2 | |
| 2H | 351 | 31206-286-158 | O RING (MITSUBA) | 1 | |

FRAME GROUP

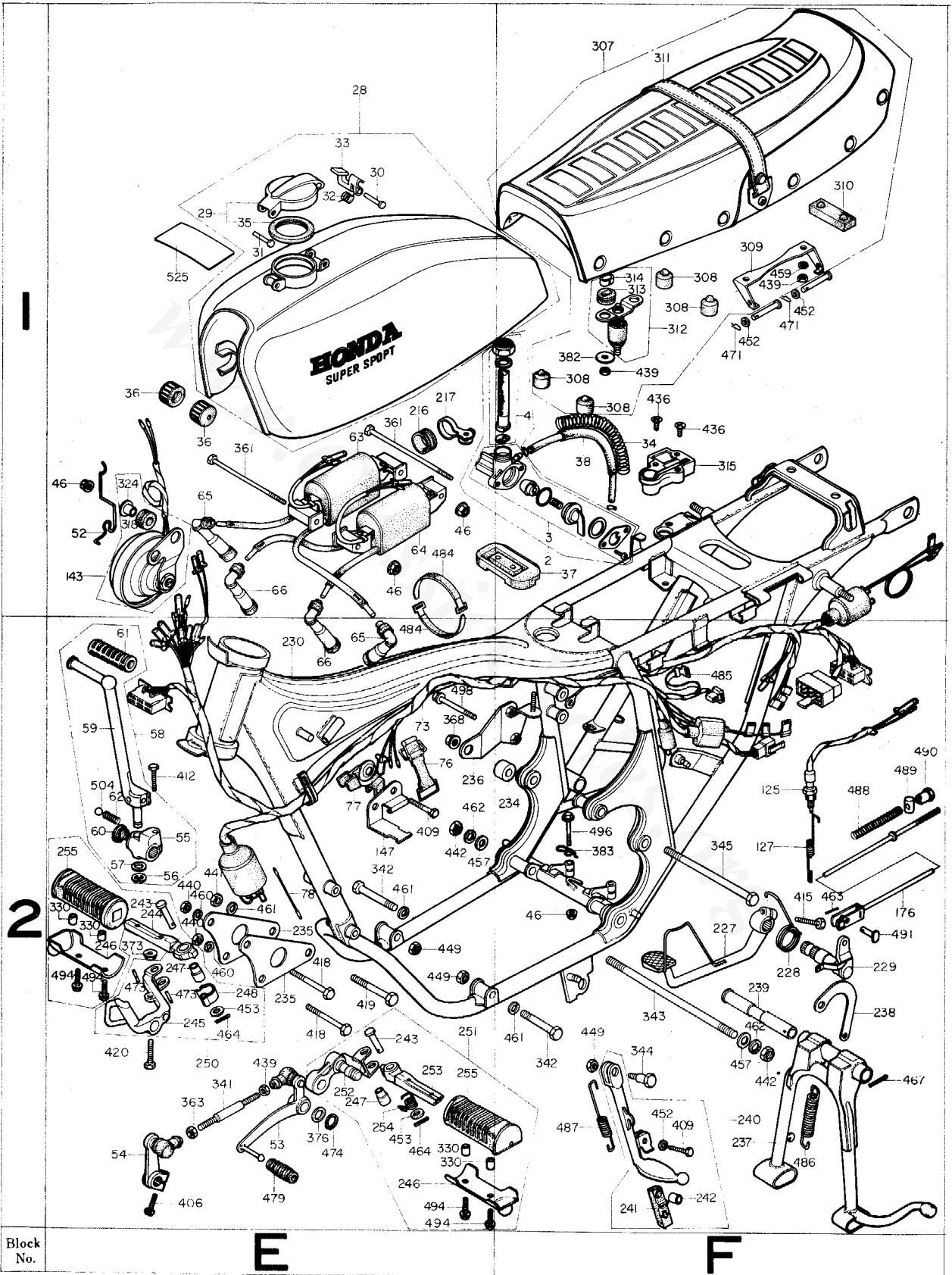

FRAME GROUP

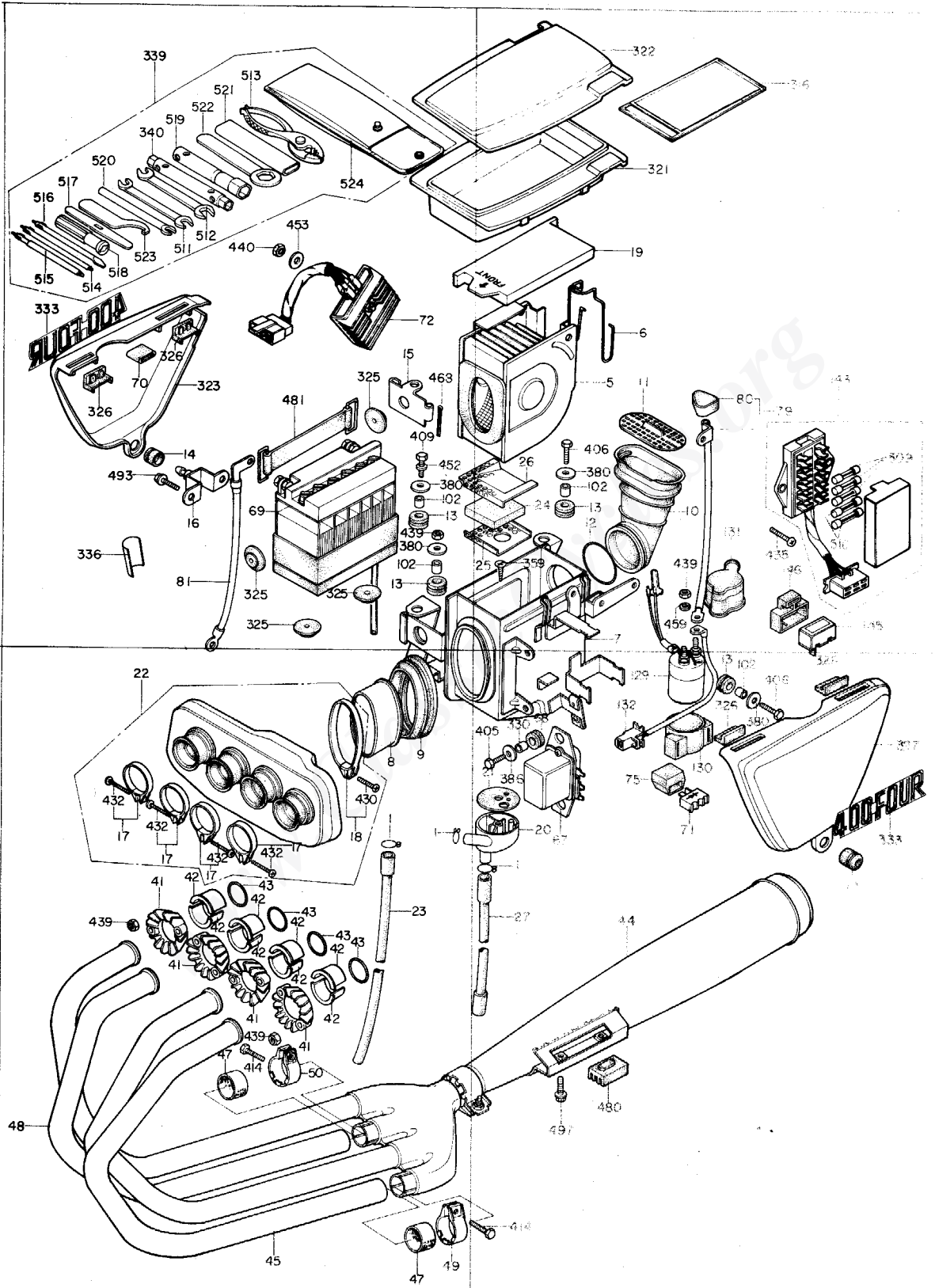

G

H

FRAME GROUP

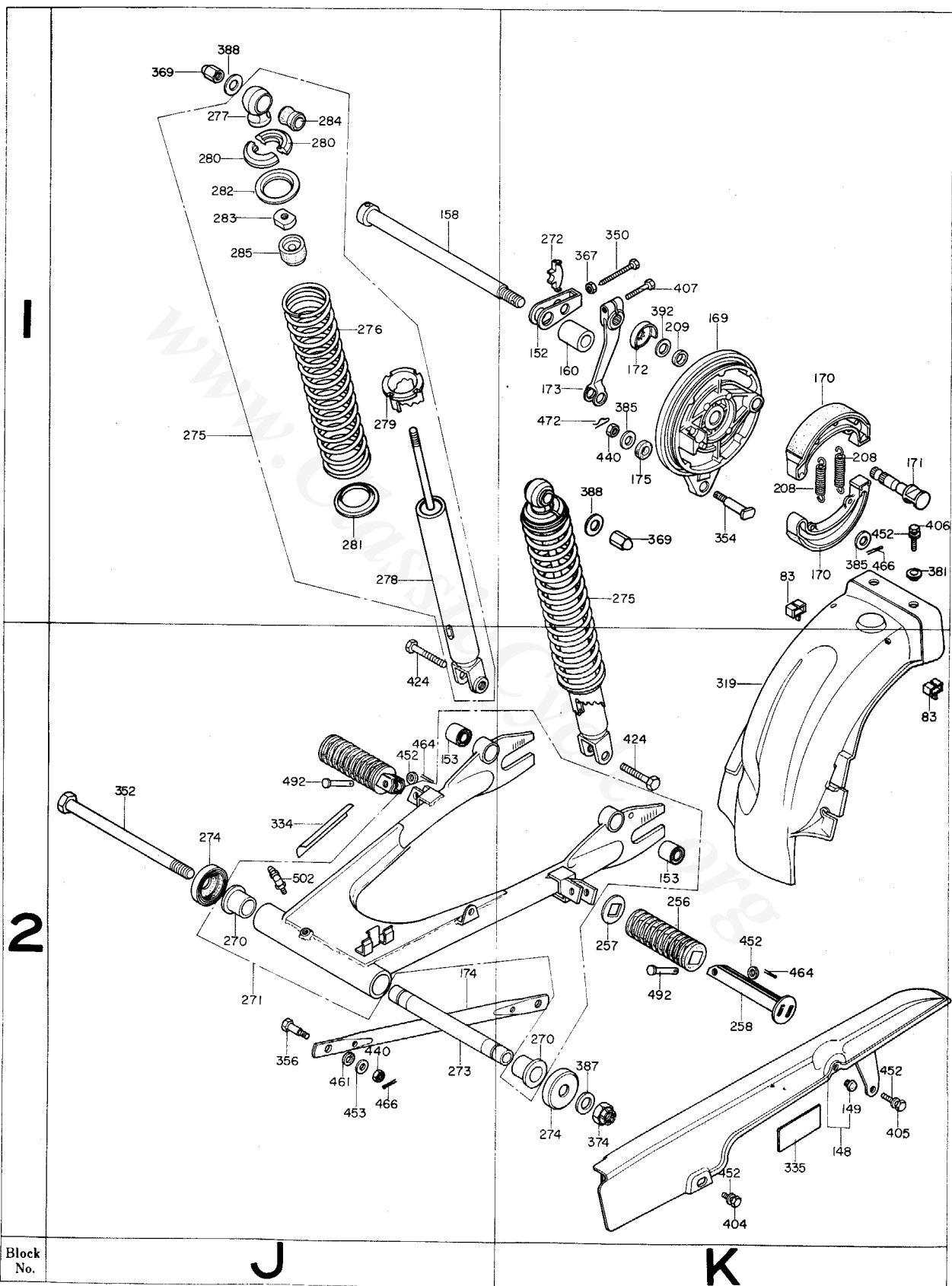

1

2

Block No.

J

K

FRAME GROUP

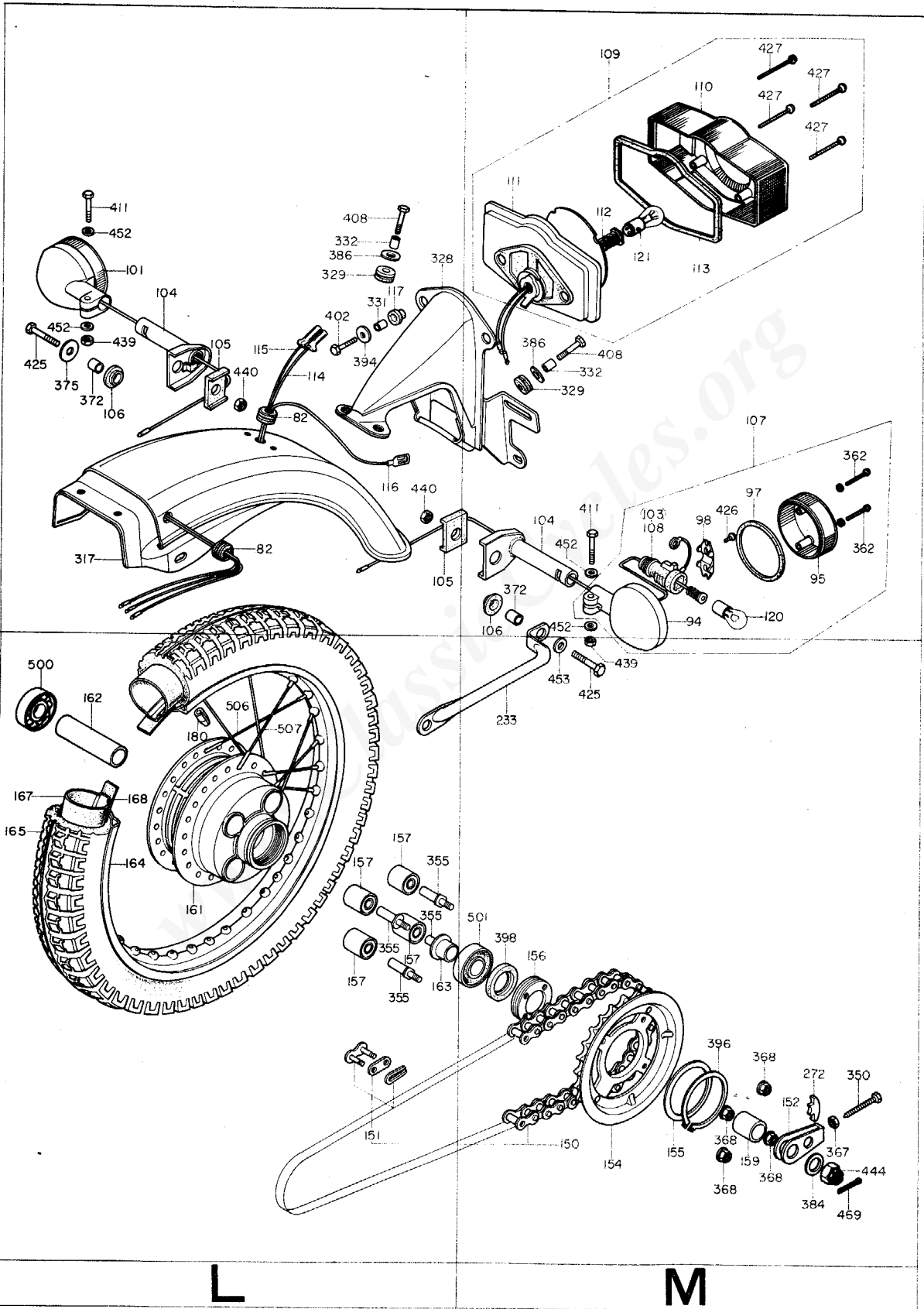

| Block No. | Ref. No. | Part No. | Description | Reqd. No. CB400F | Remarks |
|-----------|----------|-----------------|---------------------------------|---------------------|---------|
| 2G | 1 | 15772-292-010 | CLIP, BREATHER TUBE | 3 | |
| 1F | 2 | 16950-377-005 | COCK, FUEL (KEIHIN) | 1 | |
| 1F | 3 | 16951-377-005 | BODY SET, FUEL COCK (KEIHIN) | 1 | |
| 1F | 4 | 16952-341-671 | STRAINER SET, FUEL | 1 | |
| 1H | 5 | 17210-333-610 | ELEMENT, AIR CLEANER | 1 | |
| 1H | 6 | 17216-333-010 | SPRING, CLEANER ELEMENT | 1 | |
| 1H | 7 | 17230-377-010 | CASE COMP., AIR CLEANER | 1 | |
| 2G | 8 | 17235-333-000 | GUIDE, AIR DUCT | 1 | |
| 2G | 9 | 17236-333-000 | SEAL, AIR CLEANER ELEMENT | 1 | |
| 1H | 10 | 17240-333-000 | DUCT, AIR CLEANER INLET | 1 | |
| 1H | 11 | 17241-333-000 | NET, AIR INLET | 1 | |
| 1H | 12 | 17242-333-000 | BAND, AIR CLEANER INLET | 1 | |
| 1A | 13 | 17245-107-010 | RUBBER, AIR CLEANER CASE MOUNT | 7 | |
| 1G | 14 | 17245-369-000 | GROMMET, SIDE COVER | 2 | |
| 1G | 15 | 17252-333-000 | PLATE, BATTERY HINGE | 1 | |
| 1G | 16 | 17253-377-000 | BRACKET, SIDE COVER | 1 | |
| 2G | 17 | 17255-333-000 | BAND A, CLEANER CONNECTING TUBE | 4 | |
| 2G | 18 | 17256-333-000 | BAND B, CLEANER CONNECTING TUBE | 1 | |
| 1H | 19 | 17260-333-000 | LID, AIR CLEANER CASE | 1 | |
| 2H | 20 | 17271-611-010 | CHAMBER, BREATHER | 1 | |
| 2H | 21 | 17272-377-000 | PACKING, BREATHER | 1 | |
| 2G | 22 | 17300-333-000 | CHAMBER ASSY., AIR CLEANER | 1 | |
| 2G | 23 | 17335-323-000 | TUBE ASSY., BREATHER | 1 | |
| 1H | 24 | 17352-377-000 | ELEMENT B | 1 | |
| 1H | 25 | 17354-377-000 | PLATE A, PANCHING | 1 | |
| 1H | 26 | 17355-377-000 | PLATE B, PANCHING | 1 | |
| 2H | 27 | 17358-374-000 | TUBE ASSY., DRAIN | 1 | |
| 1E | 28 | 17500-377-670HX | TANK ASSY., FUEL | 1 | |
| | | 17500-377-670HW | TANK ASSY., FUEL | 1 | |
| 1E | 29 | 17510-323-310 | CAP COMP., FUEL TANK | 1 | |
| 1F | 30 | 17513-300-300 | PIN, FUEL FILLER CAP CHECK | 1 | |

| Block No. | Ref. No. | Part No. | Description | Reqd. No. CB400F | Remarks |
|-----------|----------|---------------|-------------------------------|---------------------|---------|
| 1E | 31 | 17514-323-300 | PIN B, FUEL FILLER CAP | 1 | |
| 1E | 32 | 17515-300-300 | SPRING, FUEL FILLER CAP CHECK | 1 | |
| 1E | 33 | 17517-300-340 | CHECK, FUEL FILLER CAP | 1 | |
| 1F | 34 | 17531-377-000 | SPRING, FUEL TUBE COVER | 1 | |
| 1E | 35 | 17534-323-300 | GASKET, FUEL FILLER | 1 | |
| 1E | 36 | 17611-286-000 | CUSHION, FUEL TANK FRONT | 2 | |
| 1F | 37 | 17613-377-000 | CUSHION, FUEL TANK REAR | 1 | |
| 1F | 38 | 17681-377-000 | TUBE, FUEL | 1 | |
| 1C | 39 | 17910-377-000 | CABLE COMP. A, THROTTLE | 1 | |
| 1C | 40 | 17920-377-000 | CABLE COMP. B, THROTTLE | 1 | |
| 2G | 41 | 18231-333-010 | JOINT, EXHAUST PIPE | 4 | |
| 2G | 42 | 18233-303-010 | COLLAR, EXHAUST PIPE JOINT | 8 | |
| 2G | 43 | 18291-028-000 | GASKET, EXHAUST PIPE | 4 | |
| 2H | 44 | 18300-377-305 | MUFFLER COMP., EXHAUST | 1 | |
| 2G | 45 | 18320-377-000 | PIPE 1, EXHAUST | 1 | |
| 1E | 46 | 18362-720-000 | NUT, FLANGE, 6MM | 6 | |
| 2G | 47 | 18391-375-000 | PACKING, MUFFLER | 2 | |
| 2G | 48 | 18420-377-000 | PIPE 3, EXHAUST | 1 | |
| 2G | 49 | 18431-375-000 | BAND, RIGHT PRE CHAMBER | 1 | |
| 2G | 50 | 18434-375-000 | BAND, LEFT PRE CHAMBER | 1 | |
| 1D | 51 | 22870-377-000 | CABLE COMP., CLUTCH | 1 | |
| 1E | 52 | 22872-356-000 | CLAMP, CLUTCH WIRE | 1 | |
| 2E | 53 | 24700-377-000 | PEDAL COMP., GEAR CHANGE | 1 | |
| 2E | 54 | 24710-377-000 | ARM COMP., GEAR CHANGE | 1 | |
| 2E | 55 | 28241-333-010 | JOINT, KICK ARM | 1 | |
| 2E | 56 | 28293-333-000 | CLIP, KICK STARTER ARM | 1 | |
| 2E | 57 | 28294-333-000 | WASHER, KICK ARM | 1 | |
| 2E | 58 | 28300-377-000 | ARM COMP., KICK STARTER | 1 | |
| 2E | 59 | 28301-377-000 | ARM, KICK STARTER | 1 | |
| 2E | 60 | 28305-333-010 | CAP, KICK ARM | 1 | |

| Block No. | Ref. No. | Part No. | Description | Reqd. No. CB400F | Remarks |
|-----------|----------|---------------|--------------------------------------|---------------------|---------|
| 2E | 61 | 28311-329-000 | RUBBER; KICK STARTER | 1 | |
| 2E | 62 | 28333-333-000 | SPRING; KICK STARTER STOPPER | 1 | |
| 1E | 63 | 30510-333-013 | COIL ASSY.; RIGHT IGNITION | 1 | |
| 1E | 64 | 30520-333-013 | COIL ASSY.; LEFT IGNITION | 1 | |
| 1E | 65 | 30700-300-010 | CAP ASSY. A; NOISE SUPPRESSER | 2 | |
| 1E | 66 | 30701-323-013 | CAP ASSY. B; NOISE SUPPRESSER | 2 | |
| 2H | 67 | 31400-333-004 | REGULATOR ASSY. (NO) | 1 | |
| 2H | 68 | 31403-323-000 | RUBBER; REGULATOR CUSHION | 2 | |
| 1G | 69 | 31500-310-671 | BATTERY ASSY. (12V.12AH) | 1 | |
| 1G | 70 | 31503-044-670 | RUBBER B; BATTERY MOUNT | 1 | |
| 2H | 71 | 31700-124-003 | RECTIFIER ASSY | 1 | |
| 1G | 72 | 31700-333-008 | RECTIFIER ASSY | 1 | |
| 2E | 73 | 32100-377-020 | HARNES; WIRE | 1 | |
| 2C | 74 | 32123-375-000 | CLIP D; WIRE HARNES | 1 | |
| 2H | 75 | 32135-124-300 | HOLDER; COUPLER | 1 | |
| 2E | 76 | 32161-377-000 | BAND; WIRE HARNES | 1 | |
| 2E | 77 | 32174-377-000 | HOLDER; WIRE HARNES | 1 | |
| 2E | 78 | 32200-377-671 | HARNES; SUB | 1 | |
| 1H | 79 | 32401-333-000 | CABLE; STARTER BATTERY | 1 | |
| 1H | 80 | 32412-333-000 | COVER; BATTERY TERMINAL | 1 | |
| 1G | 81 | 32601-286-000 | CABLE; BATTERY EARTH | 1 | |
| 1L | 82 | 32983-011-000 | GROMMET; WIRE CORD | 2 | |
| 1K | 83 | 32985-300-000 | GROMMET; WIRE CORD | 2 | |
| 1A | 84 | 33100-369-671 | LIGHT ASSY.; HEAD (12V 50/35W) | 1 | |
| 1A | 85 | 33101-369-670 | RIM; HEAD LIGHT | 1 | |
| 1A | 86 | 33103-333-000 | SCREW; BEAM ADJUST; 4MM | 1 | |
| 1A | 87 | 33107-333-000 | SPRING; HEAD LIGHT BEAM ADJUSTING | 1 | |
| 1A | 88 | 33117-001-023 | NUT; HEAD LIGHT BEAM ADJUSTING | 1 | |
| 1A | 89 | 33120-333-670 | LIGHT UNIT; HEAD (12V 50/35W) | 1 | |
| 1A | 90 | 33125-087-761 | SCREW; UNIT HOLDER | 2 | |

| Block No. | Ref. No. | Part No. | Description | Reqd. No. CB400F | Remarks |
|-----------|----------|---------------|--|------------------|---------|
| 1A | 91 | 33128-200-033 | NUT, UNIT HOLDER | 2 | |
| 1A | 92 | 33130-333-000 | SOCKET COMP., HEAD LIGHT | 1 | |
| 1A | 93 | 33400-377-671 | SIGNAL ASSY., RIGHT FRONT TURN (12V 32/3CP) | 1 | |
| 1A | 94 | 33401-377-671 | BASE, TURN SIGNAL | 4 | |
| 1A | 95 | 33402-377-671 | LENS, TURN SIGNAL | 4 | |
| 1A | 96 | 33405-377-671 | SOCKET COMP., RIGHT | 1 | |
| 1A | 97 | 33406-377-671 | PACKING, TURN SIGNAL LENS | 4 | |
| 1A | 98 | 33407-377-671 | HOLDER, TURN SIGNAL SOCKET | 4 | |
| 1B | 99 | 33450-377-671 | SIGNAL ASSY., LEFT FRONT TURN (12V 32/3CP) | 1 | |
| 1A | 100 | 33455-377-671 | SOCKET COMP., LEFT | 1 | |
| 1L | 101 | 33600-377-671 | SIGNAL ASSY., RIGHT REAR TURN (12V 32CP) | 1 | |
| 1G | 102 | 33603-053-650 | COLLAR, REAR TURN SIGNAL STAY | 4 | |
| 1M | 103 | 33605-377-671 | SOCKET COMP., RIGHT | 1 | |
| 1L | 104 | 33607-377-670 | STAY, REAR TURN SIGNAL | 2 | |
| 1L | 105 | 33608-300-000 | RUBBER, REAR TURN SIGNAL MOUNT | 2 | |
| 1L | 106 | 33609-292-000 | RUBBER B, REAR TURN SIGNAL MOUNT | 2 | |
| 1M | 107 | 33650-377-671 | WINKER ASSY., LEFT REAR (12V 32CP) | 1 | |
| 1M | 108 | 33655-377-671 | SOCKET COMP., LEFT | 1 | |
| 1M | 109 | 33701-342-671 | LIGHT UNIT, TAIL | 1 | |
| 1M | 110 | 33702-341-671 | LENS, TAIL LIGHT | 1 | |
| 1M | 111 | 33703-342-671 | BASE COMP., TAIL LIGHT | 1 | |
| 1M | 112 | 33708-341-671 | CORD COMP., TAIL LIGHT | 1 | |
| 1M | 113 | 33709-341-671 | PACKING, TAIL LIGHT LENS | 1 | |
| 1L | 114 | 33710-333-000 | CORD, STOP LIGHT | 1 | |
| 1L | 115 | 33711-333-000 | CORD, TAIL LIGHT SUB | 1 | |
| 1L | 116 | 33712-300-003 | CORD, TAIL LIGHT EARTH (STANLEY) | 1 | |
| 1L | 117 | 33714-077-671 | PACKING B, TAIL LIGHT BASE | 2 | |
| 1A | 118 | 33741-340-670 | REFLECTOR, FRONT REFLEX | 2 | |
| 1B | 119 | 34902-259-000 | BULB, DASH (12V 3W) | 9 | |
| 1M | 120 | 34905-268-671 | BULB, TURN SIGNAL (12V 25W) | 2 | |

| Block No. | Ref. No. | Part No. | Description | Reqd. No. CB400F | Remarks |
|-----------|----------|---------------|--|------------------|---------|
| 1A | 121 | 34906-313-671 | BULB, TAIL & STOP LIGHT (12V 23/8W) | 3 | |
| 1B | 122 | 35010-377-670 | KEY SET | 1 | |
| 1D | 123 | 35130-377-670 | SWITCH ASSY., STARTER KILL | 1 | |
| 1D | 124 | 35200-377-671 | SWITCH ASSY., TURN SIGNAL | 1 | |
| 2F | 125 | 35350-292-003 | SWITCH ASSY., STOP | 1 | |
| 1O | 126 | 35350-300-016 | SWITCH, STOP (NAILS) | 1 | |
| 1F | 127 | 35357-046-000 | SPRING, STOP SWITCH | 1 | |
| 1D | 128 | 35360-341-000 | SWITCH ASSY., CLUTCH LEVER | 1 | |
| 2H | 129 | 35850-375-000 | SWITCH ASSY., STARTER MAGNETIC | 1 | |
| 2H | 130 | 35856-286-010 | RUBBER, MAGNETIC SHOCK | 1 | |
| 1H | 131 | 35857-333-000 | COVER, MAGNETIC SWITCH | 1 | |
| 2H | 132 | 35858-333-000 | CORO, MAGNETIC SUB | 1 | |
| 1B | 133 | 37200-377-671 | METER ASSY., SPEED (MILE) | 1 | |
| 1B | 134 | 37211-377-000 | BRACKET, METER | 1 | |
| 1B | 135 | 37212-455-000 | RING, RIGHT METER SET | 1 | |
| 1B | 136 | 37213-455-000 | RING, LEFT METER SET | 1 | |
| 1B | 137 | 37242-323-701 | CUSHION, METER | 2 | |
| 1B | 138 | 37243-457-000 | COLLAR, METER SET | 4 | |
| 1B | 139 | 37244-307-670 | RUBBER, METER SET | 4 | |
| 1B | 140 | 37250-377-008 | METER ASSY., TACHO | 1 | |
| 1B | 141 | 37260-333-000 | CABLE ASSY., TACHOMETER | 1 | |
| 1B | 142 | 37600-377-018 | PILOT ASSY., COMBINATION (NIPPON SEIKI) | 1 | |
| 1E | 143 | 38100-369-004 | HORN ASSY. (MITSUBA) | 1 | |
| 1H | 144 | 38200-377-005 | BOX ASSY., FUSE (DAICHI) | 1 | |
| 1H | 145 | 38300-292-670 | RELAY ASSY., TURN SIGNAL (SIGNAL STAT) | 1 | |
| 1H | 146 | 38306-107-670 | SUSPENSION, TURN SIGNAL RELAY | 1 | |
| 2E | 147 | 38555-377-000 | STAY, SPEED UNIT | 1 | |
| 2K | 148 | 40510-377-000 | CASE, DRIVE CHAIN | 1 | |
| 2K | 149 | 40514-377-000 | PLUG, CHAIN CASE | 1 | |
| 2M | 150 | 40530-333-003 | CHAIN, DRIVE (DIO50DS-96L) (DAIO) | 1 | |
| | | 40530-333-005 | CHAIN, DRIVE (RK5GS-96L) (TAKASAGO) | 1 | |

| Block No. | Ref. No. | Part No. | Description | Reqd. No. CB400F | Remarks |
|-----------|----------|---------------|--|------------------|---------|
| 2L | 151 | 40531-333-003 | JOINT, DRIVE CHAIN (DID50DS) (DAID0) | 1 | |
| | | 40531-333-005 | JOINT, DRIVE CHAIN (RK50S) (TAKASAGO) | 1 | |
| 1K | 152 | 40543-312-010 | ADJUSTER, DRIVE CHAIN | 2 | |
| 2J | 153 | 40548-268-000 | BUSH, REAR CUSHION UNDER RUBBER | 2 | |
| 2M | 154 | 41200-367-010 | SPROCKET COMP., FINAL DRIVEN (38T) | 1 | |
| 2M | 155 | 41202-286-000 | WASHER, 70MM | 1 | |
| 2M | 156 | 41231-286-000 | RETAINER, REAR WHEEL BEARING | 1 | |
| 2L | 157 | 41241-286-000 | BUSH, REAR WHEEL DAMPER | 4 | |
| 1J | 158 | 42301-286-010 | AXLE, REAR WHEEL | 1 | |
| 2M | 159 | 42311-286-000 | COLLAR, REAR WHEEL SIDE | 1 | |
| 1K | 160 | 42313-369-000 | COLLAR, REAR BRAKE PANEL SIDE | 1 | |
| 2L | 161 | 42601-333-000 | HUB COMP., REAR WHEEL | 1 | |
| 2L | 162 | 42620-286-000 | COLLAR A, REAR AXLE DISTANCE | 1 | |
| 2L | 163 | 42625-286-000 | COLLAR B, REAR AXLE DISTANCE | 1 | |
| 2L | 164 | 42701-290-003 | RIM, REAR WHEEL (18)(DAID0) | 1 | |
| 2L | 165 | 42711-377-003 | TIRE, REAR WHEEL (3.50S-18) (BS) | 1 | |
| 2A | 166 | 42712-268-000 | TUBE, REAR WHEEL (3.00-18) | 1 | |
| 2L | 167 | 42712-287-000 | TUBE, REAR WHEEL (3.50-18) | 1 | |
| 2A | 168 | 42713-268-000 | FLAP, REAR TUBE (18)(BS) | 2 | |
| 1K | 169 | 43100-369-010 | PANEL COMP., REAR BRAKE | 1 | |
| 1K | 170 | 43120-369-670 | SHOE COMP., REAR BRAKE | 2 | |
| 1K | 171 | 43141-369-000 | CAM, REAR BRAKE | 1 | |
| 1K | 172 | 43145-369-000 | PLATE, BRAKE INDICATOR | 1 | |
| 1K | 173 | 43411-369-000 | ARM, REAR BRAKE | 1 | |
| 2J | 174 | 43431-333-000 | ARM, REAR BRAKE STOPPER | 1 | |
| 1K | 175 | 43434-286-000 | RUBBER, STOPPER ARM CUSHION | 1 | |

| Block No. | Ref. No. | Part No. | Description | Reqd. No. CB400F | Remarks |
|-----------|----------|---------------|--------------------------------------|------------------|---------|
| 2F | 176 | 43451-377-000 | ROD COMP., REAR BRAKE | 1 | |
| 2A | 177 | 44301-312-000 | AXLE, FRONT WHEEL | 1 | |
| 2B | 178 | 44311-300-000 | COLLAR, FRONT WHEEL SIDE | 1 | |
| 2A | 179 | 44601-317-702 | HUB, FRONT WHEEL | 1 | |
| 2A | 180 | 44606-283-000 | BALANCER (20G) | N | |
| | | 44607-283-000 | BALANCER (15G) | N | |
| | | 44608-283-000 | BALANCER (10G) | N | |
| | | 44609-283-000 | BALANCER (5G) | N | |
| 2A | 181 | 44620-317-701 | COLLAR, FRONT AXLE DISTANCE | 1 | |
| 2A | 182 | 44641-333-000 | RETAINER COMP., GEAR BOX | 1 | |
| 2A | 183 | 44642-317-701 | COVER, GEAR BOX RETAINER | 1 | |
| 2B | 184 | 44643-300-000 | RETAINER, FRONT WHEEL BEARING | 1 | |
| 2A | 185 | 44701-317-701 | RIM, FRONT WHEEL (14) | 1 | |
| 2A | 186 | 44711-377-003 | TIRE, FRONT WHEEL (3.00S-18) (HS) | 1 | |
| 2A | 187 | 44800-317-700 | CASING ASSY, SPEEDOMETER GEAR | 1 | |
| 1B | 188 | 44830-323-000 | CABLE ASSY., SPEEDOMETER | 1 | |
| 1B | 189 | 44831-323-000 | CABLE, SPEEDOMETER INNER | 1 | |
| 1B | 190 | 44831-333-000 | CABLE, SPEEDOMETER INNER | 1 | |
| 2B | 191 | 45100-323-053 | CALIPER ASSY. (TOKIKO) | 1 | |
| 2B | 192 | 45101-323-013 | CALIPER A (TOKIKO) | 1 | |
| 2B | 193 | 45102-323-003 | CALIPER B (TOKIKO) | 1 | |
| 2B | 194 | 45104-317-700 | JOINT, CALIPER HOLDER | 1 | |
| 2B | 195 | 45105-323-016 | PAD COMP. A (ASAHI) | 1 | |
| | | 45105-323-043 | PAD COMP. A (TOKIKO) | 1 | |
| 2B | 196 | 45106-323-006 | PAD COMP. B (ASAHI) | 1 | |
| | | 45106-323-013 | PAD COMP. B (TOKIKO) | 1 | |
| 2B | 197 | 45107-323-020 | PISTON COMP. | 1 | |
| 2B | 198 | 45108-300-003 | SEAL, PISTON (TOKIKO) | 1 | |
| 2B | 199 | 45115-323-010 | HOLDER, CALIPER | 1 | |
| 2B | 200 | 45116-323-020 | PIN, CALIPER HOLDER | 1 | |

| Block No. | Ref. No. | Part No. | Description | Reqd. No. CB400F | Remarks |
|-----------|----------|----------------|-------------------------------|---------------------|---------|
| 2B | 201 | 45117-300-020 | BOLT, CALIPER ADJUSTING | 1 | |
| 2B | 202 | 45119-333-000 | SPRING, CALIPER ADJUST | 1 | |
| 2B | 203 | 45120-369-000 | DISK COMP., FRONT BRAKE | 1 | |
| 2C | 204 | 45125-300-020 | HOSE A, FRONT BRAKE | 1 | |
| 1C | 205 | 45126-377-000 | HOSE B, FRONT BRAKE | 1 | |
| 1C | 206 | 45127-323-000 | JOINT, 3 WAY | 1 | |
| 2B | 207 | 45128-317-701 | PIPE, FRONT BRAKE | 1 | |
| 1K | 208 | 45133-329-000 | SPRING, FRONT BRAKE SHOE | 2 | |
| 1K | 209 | 45134-250-000 | SEAL, BRAKE CAM DUST | 1 | |
| 2B | 210 | 45140-333-000 | COVER COMP., DISK | 1 | |
| 2C | 211 | 45146-300-000 | GROMMET, BRAKE HOSE | 1 | |
| 2B | 212 | 45224-579-013 | VALVE, BLEEDER | 1 | |
| 2B | 213 | 45225-579-013 | CAP, BLEEDER | 1 | |
| 2A | 214 | 45451-283-000 | GROMMET, WIRE | 1 | |
| 1B | 215 | 45465-370-000 | CLIP, FRONT BRAKE CABLE | 1 | |
| 1E | 216 | 45466-329-000 | INNER, CABLE GUIDE | 1 | |
| 1E | 217 | 45467-329-000 | CLIP A, FRONT BRAKE CABLE | 1 | |
| 1C | 218 | 45500-369-671 | CYLINDER ASSY., MASTER | 1 | |
| 1C | 219 | 45513-341-771 | CAP, OIL CUP | 1 | |
| 1C | 220 | 45517-300-003 | HOLDER, MASTER CYLINDER | 1 | |
| 1C | 221 | 45520-300-000 | DIAPHRAGM | 1 | |
| 1C | 222 | 45521-300-010 | PLATE, DIAPHRAGM | 1 | |
| 1C | 223 | 45522-300-010 | BOOT, MASTER CYLINDER | 1 | |
| 1C | 224 | 45526-341-000 | BUSH, RIGHT HANDLE LEVER | 1 | |
| 1C | 225 | 45527-300-000 | PLATE, LEVER BUSH SETTING | 1 | |
| 1C | 226 | 45530-377-305 | CYLINDER SET, MASTER | 1 | |
| 2F | 227 | 46500-377-000 | PEDAL COMP., BRAKE | 1 | |
| 2F | 228 | 46514-377-000 | SPRING, BRAKE PEDAL | 1 | |
| 2F | 229 | 46515-377-000 | SHAFT COMP., REAR BRAKE PIVOT | 1 | |
| 2E | 230 | 5C100-377-000R | BODY COMP., FRAME | 1 | |

| Block No. | Ref. No. | Part No. | Description | Reqd. No. CB400F | Remarks |
|-----------|----------|----------------|------------------------------------|---------------------|---------|
| 1D | 231 | 50301-268-305 | RACE, STEERING TOP BALL | 1 | |
| 1D | 232 | 50302-268-305 | RACE, STEERING BOTTOM BALL | 1 | |
| 1M | 233 | 50316-377-000 | GRIP, SIDE | 1 | |
| 2E | 234 | 50329-286-010 | COLLAR, ENGINE SIDE | 1 | |
| 2E | 235 | 50351-377-000B | PLATE, FRONT ENGINE HANGER | 2 | |
| 2E | 236 | 50356-377-000B | BRACKET, REAR ENGINE HANGER | 1 | |
| 2F | 237 | 50500-377-000B | STAND COMP., MAIN | 1 | |
| 2F | 238 | 50523-333-000 | HOOK, MAIN STAND SPRING | 1 | |
| 2F | 239 | 50526-286-000 | PIPE, MAIN STAND PIVOT | 1 | |
| 2F | 240 | 50540-377-670B | BAR ASSY., SIDE STAND | 1 | |
| 2F | 241 | 50548-356-700 | RUBBER, STAND | 1 | |
| 2F | 242 | 50549-356-700 | COLLAR, STAND RUBBER SET | 1 | |
| 2E | 243 | 50603-033-000 | PIN, STEP BAR JOINT | 2 | |
| 2E | 244 | 50616-377-000 | ARM COMP, RIGHT STEP | 1 | |
| 2E | 245 | 50618-377-000B | BAR COMP, RIGHT STEP | 1 | |
| 2E | 246 | 50619-375-000 | STOPPER, STEP RUBBER | 2 | |
| 2E | 247 | 50620-310-000 | INNER PIPE, STEP | 2 | |
| 2E | 248 | 50620-377-000 | SPRING, RIGHT STEP RETURN | 1 | |
| 2E | 250 | 50630-377-000B | STEP ASSY., RIGHT | 1 | |
| 2E | 251 | 50640-377-000B | STEP ASSY., LEFT | 1 | |
| 2E | 252 | 50641-377-000B | BAR COMP., LEFT STEP | 1 | |
| 2E | 253 | 50642-369-670B | ARM COMP., LEFT STEP | 1 | |
| 2E | 254 | 50644-283-000 | SPRING, LEFT STEP RETURN | 1 | |
| 2E | 255 | 50661-369-000 | RUBBER, STEP | 2 | |
| 2K | 256 | 50710-377-000 | RUBBER, PILLION STEP | 2 | |
| 2K | 257 | 50712-377-000 | WASHER, PILLION STEP | 2 | |
| 2K | 258 | 50715-377-000 | BAR, PILLION STEP | 2 | |
| 2O | 259 | 51400-377-003 | FORK ASSY., RIGHT FRONT (SHOWA) | 1 | |
| 2D | 260 | 51401-369-000 | SPRING, FRONT SHOCK ABSORBER | 2 | |

| Block No. | Ref. No. | Part No. | Description | Reqd. No. CB400F | Remarks |
|-----------|----------|----------------|--|---------------------|---------|
| 2D | 261 | 51411-369-000 | PIPE COMP., FRONT FORK | 2 | |
| 2D | 262 | 51412-369-000 | SPRING, FRONT SHOCK ABSORBER REBOUND | 2 | |
| 2D | 263 | 51421-369-000 | CASE, RIGHT FRONT FORK BOTTOM | 1 | |
| 2D | 264 | 51425-369-000 | SEAL, FRONT FORK DUST | 2 | |
| 2D | 265 | 51432-369-000 | PIECE, OIL LOCK | 2 | |
| 2D | 266 | 51437-369-000 | RING, PISTON | 2 | |
| 2D | 267 | 51470-377-003 | PIPE COMP., SEAT (SHOWA) | 2 | |
| 2D | 268 | 51500-377-003 | FORK ASSY., LEFT FRONT (SHOWA) | 1 | |
| 2D | 269 | 51521-369-000 | CASE, LEFT FRONT FORK BOTTOM | 1 | |
| 2J | 270 | 52108-457-300 | BUSH, REAR FORK PIVOT | 2 | |
| 2J | 271 | 52110-377-000H | FORK ASSY., REAR | 1 | |
| 1K | 272 | 52136-333-000 | STOPPER, CHAIN ADJUSTER | 2 | |
| 2J | 273 | 52141-369-000 | COLLAR, REAR FORK CENTER | 1 | |
| 2J | 274 | 52144-362-000 | CAP, REAR FORK DUST SEAL | 2 | |
| 1J | 275 | 52400-375-000 | ABSORBER ASSY., REAR SHOCK | 2 | |
| 1J | 276 | 52401-323-000 | SPRING, SHOCK ABSORBER | 2 | |
| 1J | 277 | 52403-312-000 | JOINT, UPPER | 2 | |
| 1J | 278 | 52410-323-670 | DAMPER ASSY., REAR | 2 | |
| 1J | 279 | 52422-329-000 | ADJUSTER, REAR SHOCK ABSORBER SPRING | 2 | |
| 1J | 280 | 52424-331-000 | STOPPER, SPRING SEAT | 4 | |
| 1J | 281 | 52458-329-000 | SEAT, REAR SHOCK ABSORBER SPRING UNDER | 2 | |
| 1J | 282 | 52459-312-003 | SEAT, REAR SHOCK ABSORBER SPRING UPPER | 2 | |
| 1J | 283 | 52482-312-000 | NUT, LOCK, TOP | 2 | |
| 1J | 284 | 52484-292-000 | RUBBER, JOINT | 2 | |
| 1J | 285 | 52517-312-000 | RUBBER, REAR SHOCK ABSORBER STOPPER | 2 | |
| 1D | 286 | 53100-377-000 | PIPE, STEERING HANDLE | 1 | |
| 2D | 287 | 53124-250-000 | SEAL, STEERING HEAD DUST | 1 | |
| 1O | 288 | 53141-300-010 | PIPE, THROTTLE GRIP | 1 | |
| 1O | 289 | 53170-369-003 | LEVER COMP., RIGHT STEERING HANDLE (JOYO) | 1 | |
| 1D | 290 | 53190-369-700 | LEVER COMP., LEFT STEERING HANDLE | 1 | |

| Block No. | Ref. No. | Part No. | Description | Reqd. No. CB400F | Remarks |
|-----------|----------|----------------|------------------------------------|---------------------|---------|
| 1D | 291 | 53192-268-000 | BOLT, CLUTCH WIRE ADJUSTING | 1 | |
| 2C | 292 | 53200-377-010B | STEM COMP., STEERING | 1 | |
| 1C | 293 | 53208-369-000 | HOLDER, 3WAY JOINT | 1 | |
| 1D | 294 | 53211-268-305 | RACE, STEERING TOP CONE | 1 | |
| 2D | 295 | 53212-250-305 | RACE, STEERING BOTTOM CONE | 1 | |
| 2D | 296 | 53215-250-000 | WASHER, STEERING HEAD DUST SEAL | 1 | |
| 1D | 297 | 53220-286-000 | THREAD COMP., STEERING HEAD TOP | 1 | |
| 1D | 298 | 53231-377-000 | BRIDGE, FORK TOP | 1 | |
| 1A | 299 | 61100-377-000 | FENDER COMP., FRONT | 1 | |
| 1A | 300 | 61301-369-003B | CASE, HEAD LIGHT (STANLEY) | 1 | |
| 1A | 301 | 61302-292-000 | COLLAR, HEAD LIGHT CASE | 2 | |
| 1A | 302 | 61303-336-000 | WASHER, HEAD LIGHT CASE | 2 | |
| 1A | 303 | 61304-292-000 | COLLAR, HEAD LIGHT SETTING | 2 | |
| 1A | 304 | 61305-333-010 | GROMMET, HEAD LIGHT CASE | 1 | |
| 1A | 305 | 61306-333-003 | GROMMET, HEAD LIGHT CASE | 1 | |
| 1A | 306 | 61313-377-670B | STAY COMP., HEAD LIGHT | 1 | |
| 1F | 307 | 77200-377-000 | SEAT COMP., DOUBLE | 1 | |
| 1F | 308 | 77201-074-000 | RUBBER, SEAT CUSHION | 4 | |
| 1F | 309 | 77201-369-000 | HINGE, SEAT | 1 | |
| 1F | 310 | 77204-312-000 | RUBBER, SEAT SETTING | 1 | |
| 1F | 311 | 77210-377-000 | LEATHER COMP., SEAT | 1 | |
| 1F | 312 | 77220-340-011 | BAR ASSY., SEAT LOCK | 1 | |
| 1F | 313 | 77228-340-001 | RUBBER, LOCK BAR CUSHION | 2 | |
| 1F | 314 | 77229-340-001 | COLLAR, SEAT LOCK BAR | 2 | |
| 1F | 315 | 77230-377-003 | LOCK ASSY., SEAT (TOYO) | 1 | |
| 1H | 316 | 77251-342-000 | BAG, SERVICE BOOK | 1 | |
| 1L | 317 | 80100-377-000 | FENDER COMP., REAR | 1 | |
| 1E | 318 | 80101-283-000 | RUBBER, REAR FENDER CUSHION | 2 | |
| 2K | 319 | 80105-333-000 | FENDER B ASSY., REAR | 1 | |
| 1A | 320 | 80109-329-000 | COLLAR C, MOUNTING 6.3 | 3 | |

| Block No. | Ref. No. | Part No. | Description | Reqd. No. CB400F | Remarks |
|-----------|----------|-----------------|------------------------------------|---------------------|---------|
| 1H | 321 | 83501-333-020 | TRAY, TOOL | 1 | |
| 1H | 322 | 83502-333-000 | LID, TOOL TRAY | 1 | |
| 1G | 323 | 83600-377-000HX | COVER, RIGHT SIDE | 1 | |
| | | 83600-377-000MW | COVER, RIGHT SIDE | 1 | |
| 1E | 324 | 83601-357-000 | COLLAR, COVER SET | 2 | |
| 1G | 325 | 83618-323-000 | RUBBER, BATTERY BOX | 4 | |
| 1G | 326 | 83621-333-000 | GROMMET, SIDE COVER | 4 | |
| 2H | 327 | 83700-377-000HX | COVER, LEFT SIDE | 1 | |
| | | 83700-377-000MW | COVER, LEFT SIDE | 1 | |
| 1L | 328 | 84701-377-670XM | BRACKET, NUMBER PLATE | 1 | |
| 1L | 329 | 84705-377-000 | RUBBER, NUMBER BRACKET | 3 | |
| 2E | 330 | 84706-286-000 | COLLAR, NUMBER BRACKET SET | 6 | |
| 1L | 331 | 84706-342-000 | COLLAR, TAIL LIGHT UNIT | 2 | |
| 1L | 332 | 84707-342-000 | COLLAR, NUMBER BRACKET SET | 3 | |
| 1G | 333 | 87128-377-000 | EMBLEM, SIDE COVER | 2 | |
| 2J | 334 | 87504-028-670 | MARK, MUFFLER CAUTION | 1 | |
| 2K | 335 | 87505-377-670 | MARK, TIRE CAUTION | 1 | |
| 1G | 336 | 87506-377-670 | MARK, BATTERY CAUTION | 1 | |
| 1D | 337 | 88100-333-004 | MIRROR, RIGHT REAR VIEW | 1 | |
| 1D | 338 | 88120-333-004 | MIRROR, LEFT REAR VIEW | 1 | |
| 1G | 339 | 89010-377-000 | TOOL SET | 1 | |
| 1G | 340 | 89216-333-000 | WRENCH, BOX, 10X12 | 1 | |
| 2E | 341 | 90065-377-000 | BOLT, TIE ROD | 1 | |
| 2E | 342 | 90106-333-000 | BOLT, FRONT ENGINE LOWER HANGER | 2 | |
| 2F | 343 | 90107-333-000 | BOLT, REAR ENGINE LOWER HANGER | 1 | |
| 2F | 344 | 90108-283-000 | SCREW, SIDE STAND PIVOT | 1 | |
| 2F | 345 | 90108-333-000 | BOLT, REAR ENGINE UPPER HANGER | 1 | |

| Block No. | Ref. No. | Part No. | Description | Reqd. No. CB400F | Remarks |
|-----------|----------|---------------|--------------------------------|------------------|---------|
| 1D | 346 | 90111-362-000 | BOLT, FLANGE, 8X36 | 4 | |
| 1C | 347 | 90114-300-000 | BOLT, HANDLE LEVER PIVOT | 1 | |
| 1C | 348 | 90114-310-000 | BOLT, HANDLE LEVER PIVOT | 1 | |
| 2D | 349 | 90116-283-010 | BOLT, SOCKET, 8MM | 2 | |
| 1K | 350 | 90119-283-000 | BOLT, CHAIN ADJUSTING | 2 | |
| 1A | 351 | 90120-377-000 | BOLT, HEAD LIGHT STAY | 2 | |
| 2J | 352 | 90121-369-000 | BOLT, REAR FORK PIVOT | 1 | |
| 2A | 353 | 90122-317-702 | BOLT, 8X90 | 4 | |
| 1K | 354 | 90127-283-000 | BOLT, REAR BRAKE PANEL STOPPER | 1 | |
| 2L | 355 | 90128-369-000 | BOLT, SPROCKET FIXING | 4 | |
| 2J | 356 | 90133-286-000 | BOLT, REAR BRAKE STOPPER ARM | 1 | |
| 1C | 357 | 90145-300-000 | BOLT, OIL | 3 | |
| 1B | 358 | 90159-356-000 | BOLT, METER SETTING | 2 | |
| 1H | 359 | 90163-538-000 | SCREW, TAPPING, 6X18 | 1 | |
| 2B | 360 | 90165-323-000 | BOLT, CALIPER SETTING | 2 | |
| 1E | 361 | 90167-333-000 | BOLT, HEX., 6X130 | 2 | |
| 1A | 362 | 90192-377-671 | SCREW, PAN, 4X25 | 8 | |
| 2E | 363 | 90201-700-000 | NUT, GOVERNER ARM FIXING | 1 | |
| 1B | 364 | 90282-329-000 | NUT, M6X15 | 2 | |
| 1D | 365 | 90304-323-670 | NUT, STEERING STEM | 1 | |
| 2B | 366 | 90305-333-000 | NUT, FRONT WHEEL AXLE | 1 | |
| 1K | 367 | 90307-283-000 | NUT, CHAIN ADJUSTING | 2 | |
| 2E | 368 | 90308-357-000 | NUT, HEX., 10MM | 5 | |
| 1J | 369 | 90309-315-000 | NUT, REAR SHOCK ABSORBER UPPER | 2 | |
| 2B | 370 | 90309-357-000 | NUT, HEX., 8MM | 4 | |
| 1D | 371 | 90321-315-670 | NUT, FIXING | 1 | |
| 1L | 372 | 90324-300-000 | COLLAR, 8MM | 2 | |
| 2E | 373 | 90352-122-003 | NUT, DRIVEN SPROCKET | 1 | |
| 2K | 374 | 90354-268-000 | NUT, SELF LOCK, 14MM | 1 | |
| 1L | 375 | 90428-844-650 | WASHER, 8MM | 1 | |

| Block No. | Ref. No. | Part No. | Description | Reqd. No. CB400F | Remarks |
|-----------|----------|----------------|------------------------------------|---------------------|---------|
| 2E | 376 | 90474-703-000 | WASHER, 12MM | 1 | |
| 1B | 377 | 90500-455-000 | WASHER, METER MOUNT, 19MM | 4 | |
| 1D | 378 | 90501-310-000 | WASHER, 7X12 | 1 | |
| 1D | 379 | 90503-283-000 | WASHER, STEERING STEM | 1 | |
| 1B | 380 | 90506-500-000 | WASHER, AIR DUCT | 6 | |
| 1K | 381 | 90512-300-000 | WASHER, 6X20 | 2 | |
| 1F | 382 | 90514-700-000 | WASHER, TANK COLLAR LOCK | 2 | |
| 2F | 383 | 90515-377-000 | GUIDE, BREATHER PIPE | 2 | |
| 2M | 384 | 90523-286-000 | WASHER, 16.5X30 | 1 | |
| 1K | 385 | 90524-030-000 | WASHER A, HANDLE HOLDER SETTING | 2 | |
| 2H | 386 | 90525-030-000 | WASHER B, HANDLE HOLDER SETTING | 5 | |
| 2K | 387 | 90526-216-000 | WASHER, 14X26 | 1 | |
| 1J | 388 | 90527-230-000 | WASHER, PLAIN, 10.3MM | 2 | |
| 2D | 389 | 90543-273-000 | PACKING, FRONT FORK DRAIN COCK | 2 | |
| 2D | 390 | 90544-283-000 | WASHER, SPECIAL, 8MM | 2 | |
| 1C | 391 | 90545-300-000 | WASHER, OIL BOLT | 7 | |
| 1K | 392 | 90549-121-000 | WASHER, PLAIN, 14MM | 1 | |
| 1C | 393 | 90555-283-000 | WASHER, SPECIAL, 8MM | 4 | |
| 1L | 394 | 90581-342-000 | WASHER, 20MM | 2 | |
| 2D | 395 | 90601-369-000 | RING, OIL SEAL STOPPER | 2 | |
| 2M | 396 | 90665-286-000 | OIL GRIP, EXTERNAL, 69MM | 1 | |
| 2B | 397 | 91252-300-003 | DUST SEAL, 22X36X8 | 1 | |
| 2M | 398 | 91253-286-013 | DUST SEAL, 30X45X9.5 | 1 | |
| 2D | 399 | 91255-369-000 | OIL SEAL, 33X46X10.5 | 2 | |
| 2B | 400 | 91259-333-000 | O-RING, 9.5X1.7 | 2 | |
| 2A | 401 | 91302-317-700 | O-RING, RETAINER | 1 | |
| 1L | 402 | 92000-05020-0A | BOLT, HEX., 5X20 | 2 | |
| 2D | 403 | 92000-06008 | BOLT, HEX., 6X8 | 2 | |
| 2K | 404 | 92000-06012 | BOLT, HEX., 6X12 | 1 | |
| 2H | 405 | 92000-06016 | BOLT, HEX., 6X16 | 9 | |

| Block No. | Ref. No. | Part No. | Description | Reqd. No. CB400F | Remarks |
|-----------|----------|----------------|-------------------|---------------------|---------|
| 2E | 406 | 92000-06020 | BOLT, HEX., 6X20 | 7 | |
| 1K | 407 | 92000-06022 | BOLT, HEX., 6X22 | 1 | |
| 1L | 408 | 92000-08025-02 | BOLT, HEX., 6X25 | 3 | |
| 1C | 409 | 92000-06025 | BOLT, HEX., 6X25 | 3 | |
| 2E | 410 | 92000-06028 | BOLT, HEX., 6X28 | 3 | |
| 1A | 411 | 92000-06035-02 | BOLT, HEX., 6X35 | 4 | |
| 2E | 412 | 92000-06036 | BOLT, HEX., 6X36 | 1 | |
| 2C | 413 | 92000-08016-0A | BOLT, HEX., 8X16 | 1 | |
| 2G | 414 | 92000-08025-0A | BOLT, HEX., 8X25 | 2 | |
| 2F | 415 | 92000-08028-0A | BOLT, HEX., 8X28 | 1 | |
| 2C | 416 | 92000-08032-0A | BOLT, HEX., 8X32 | 2 | |
| 1D | 417 | 92000-08056-0B | BOLT, HEX., 8X56 | 2 | |
| 2E | 418 | 92000-08080-0A | BOLT, HEX., 8X80 | 2 | |
| 2E | 419 | 92000-10080-0A | BOLT, HEX., 10X80 | 1 | |
| 2E | 420 | 92023-06025 | BOLT, HEX., 6X25 | 1 | |
| 2B | 421 | 92200-06028 | BOLT, HEX., 6X28 | 2 | |
| 2B | 422 | 92700-08045 | BOLT, STUD, 8X45 | 1 | |
| 2D | 423 | 92700-08050-30 | BOLT, STUD, 8X50 | 4 | |
| 2J | 424 | 93000-10032-0B | BOLT, HEX., 10X32 | 2 | |
| 1L | 425 | 93100-08040-0B | BOLT, HEX., 8X40 | 2 | |
| 1A | 426 | 93500-03006-0A | SCREW, PAN, 3X6 | 8 | |
| 1M | 427 | 93500-04055-0B | SCREW, PAN, 4X55 | 4 | |
| 1B | 428 | 93500-05006-0G | SCREW, PAN, 5X6 | 1 | |
| 1B | 429 | 93500-05010-0G | SCREW, PAN, 5X10 | 2 | |
| 2G | 430 | 93500-05016-0A | SCREW, PAN, 5X16 | 1 | |
| 1A | 431 | 93500-05016-0B | SCREW, PAN, 5X16 | 2 | |
| 2G | 432 | 93500-05025-0A | SCREW, PAN, 5X25 | 7 | |
| 1C | 434 | 93500-05032-0A | SCREW, PAN, 5X32 | 1 | |
| 1H | 435 | 93500-06016 | SCREW, PAN, 6X16 | 2 | |

| Block Ref. No. No. | Part No. | Description | Reqd. No. CB400F | Remarks |
|-----------------------|----------------|----------------------|---------------------|---------|
| 1 F 436 | 93600-06012-07 | SCREW, FLAT, 6X12 | 2 | |
| 2 A 437 | 93700-05016-0A | SCREW, OVAL, 5X16 | 1 | |
| 1 B 438 | 93902-24280 | SCREW, TAPPING, 4X10 | 3 | |
| 1 A 439 | 94001-06000 | NUT, HEX., 6MM | 22 | |
| 2 B 440 | 94001-08000-0S | NUT, HEX., 8MM | 8 | |
| 2 E 441 | 94001-10000-0S | NUT, HEX., 10MM | 1 | |
| 2 E 442 | 94001-12200 | NUT, HEX., 12MM | 2 | |
| 1 C 443 | 94002-06000 | NUT, HEX., 6MM | 1 | |
| 2 M 444 | 94011-16220-0S | NUT, CASTLE, 16MM | 1 | |
| 2 B 445 | 94021-06020 | NUT, HEX. CAP, 6MM | 4 | |
| 1 B 446 | 94021-08020-0S | NUT, CAP, 8MM | 2 | |
| 1 C 447 | 94021-08021-0S | NUT, HEX. CAP, 8MM | 2 | |
| 2 D 448 | 94030-08000 | NUT, HEX., 8MM | 4 | |
| 2 E 449 | 94030-10000 | NUT, HEX., 10MM | 3 | |
| 1 A 450 | 94101-04000 | WASHER, PLAIN, 4MM | 1 | |
| 1 B 451 | 94101-05700 | WASHER, PLAIN, 5MM | 1 | |
| 1 A 452 | 94101-06000 | WASHER, PLAIN, 6MM | 30 | |
| 2 D 453 | 94101-08000 | WASHER, PLAIN, 8MM | 13 | |
| 1 A 454 | 94101-10000 | WASHER, PLAIN, 10MM | 2 | |
| 2 C 455 | 94102-08000 | WASHER, PLAIN, 8MM | 1 | |
| 2 B 456 | 94102-10000 | WASHER, PLAIN, 10MM | 2 | |
| 2 E 457 | 94102-12000 | WASHER, PLAIN, 12MM | 2 | |
| 1 A 458 | 94111-05000 | WASHER, SPRING, 5MM | 2 | |
| 2 B 459 | 94111-06000 | WASHER, SPRING, 6MM | 8 | |
| 2 B 460 | 94111-08000 | WASHER, SPRING, 8MM | 9 | |
| 1 A 461 | 94111-10000 | WASHER, SPRING, 10MM | 5 | |
| 2 E 462 | 94111-12000 | WASHER, SPRING, 12MM | 2 | |
| 2 F 463 | 94201-16120 | PIN, SPLIT, 1.6X12 | 1 | |
| 2 E 464 | 94201-16150 | PIN, SPLIT, 1.6X15 | 4 | |
| 2 B 465 | 94201-16220 | PIN, SPLIT, 1.6X22 | 1 | |

| Block No. | Ref. No. | Part No. | Description | Reqd. No. CB400F | Remarks |
|-----------|----------|-------------|-------------------------|------------------|---------|
| 2J | 466 | 94201-20150 | PIN, SPLIT, 2.0X15 | 2 | |
| 2F | 467 | 94201-25250 | PIN, SPLIT, 2.5X25 | 1 | |
| 1G | 468 | 94201-30450 | PIN, SPLIT, 3.0X45 | 1 | |
| 2M | 469 | 94201-40300 | PIN, SPLIT, 4.0X30 | 1 | |
| 1A | 470 | 94251-05000 | PIN, LOCK, 5MM | 2 | |
| 1F | 471 | 94251-06000 | PIN, LOCK, 6MM | 2 | |
| 1K | 472 | 94251-08000 | PIN, LOCK, 8MM | 1 | |
| 2E | 473 | 94305-40163 | PIN, SPRING, 4X16 | 2 | |
| 2E | 474 | 94511-12000 | CIR CLIP, 12MM | 1 | |
| 1D | 475 | 94605-27101 | BOLT DL, FORK | 2 | |
| 1D | 476 | 94608-50000 | O-RING, 23X2.3 | 2 | |
| 10 | 477 | 95011-14100 | GRIP, RIGHT HANDLE | 1 | |
| 1D | 478 | 95011-14200 | GRIP, LEFT HANDLE | 1 | |
| 2E | 479 | 95011-40000 | RUBBER, CHANGE PEDAL | 1 | |
| 2H | 480 | 95011-61000 | RUBBER A, STAND STOPPER | 1 | |
| 1G | 481 | 95012-17000 | BAND A, BATTERY | 1 | |
| 1D | 482 | 95014-22200 | HOLDER B2, UPPER | 2 | |
| 2D | 483 | 95014-41000 | HOLDER, AXLE | 2 | |
| 1E | 484 | 95014-61100 | BAND A1, WIRE | 2 | |
| 2F | 485 | 95014-62200 | BAND B2, WIRE | 1 | |
| 2F | 486 | 95014-71700 | SPRING G, PAIN STAND | 1 | |
| 2F | 487 | 95014-72401 | SPRING U, SIDE STAND | 1 | |
| 2F | 488 | 95014-73300 | SPRING C, BRAKE ROD | 1 | |
| 2F | 489 | 95015-32000 | JOINT B, BRAKE ARM | 1 | |
| 2F | 490 | 95015-42000 | NUT B, ADJUST | 1 | |
| 2F | 491 | 95015-52000 | PIN B, JOINT | 1 | |
| 2J | 492 | 95015-81000 | PIN A, PILLION STEP | 2 | |
| 1G | 493 | 95700-06014 | BOLT, FLANGE, 6X14 | 2 | |
| 2E | 494 | 95700-06018 | BOLT, FLANGE, 6X18 | 4 | |
| 1A | 495 | 95700-06025 | BOLT, FLANGE, 6X25 | 2 | |

| Block Ref. No. | Part No. | Description | Reqd. No. CB400F | Remarks |
|----------------|----------------|--------------------------------|------------------|---------|
| 2F 496 | 95700-06040 | BOLT, FLANGE, 6X40 | 2 | |
| 2H 497 | 95700-08016 | BOLT, FLANGE, 8X16 | 2 | |
| 2E 498 | 95700-08065 | BOLT, FLANGE, 8X65 | 2 | |
| 2A 499 | 96140-63020-10 | BEARING, RADIAL BALL, 6302 | 2 | |
| 2L 500 | 96140-63030-10 | BEARING, RADIAL BALL, 6303 | 1 | |
| 2M 501 | 96140-63040-10 | BEARING, RADIAL BALL, 6304 | 1 | |
| 2J 502 | 96201-80000 | NIPPLE, GREACE, B-T6S | 1 | |
| 1D 503 | 96211-08000 | BALL, STEEL, #8 | 37 | |
| 2E 504 | 96211-10000 | BALL, STEEL, #10 | 1 | |
| 2A 505 | 97311-69233-10 | SPOKE, BS 8X196.5 (INSIDE) | 18 | |
| 2L 506 | 97339-52159-10 | SPOKE, B 9X159.5 (INSIDE) | 18 | |
| 2L 507 | 97715-52158-10 | SPOKE, B 9X159 (OUTSIDE) | 18 | |
| 2A 508 | 97716-69232-10 | SPOKE, BS 8X196.0 (OUTSIDE) | 18 | |
| 1H 509 | 98200-20700 | FUSE, 7A | 3 | |
| 1H 510 | 98200-21500 | FUSE, 15A | 2 | |
| 1G 511 | 99001-10120 | SPANNER, 10X12 | 1 | |
| 1G 512 | 99001-14170 | SPANNER, 14X17 | 1 | |
| 1G 513 | 99002-13500 | PLIERS, 135 | 1 | |
| 1G 514 | 99003-10000 | DRIVER, PLUS, #2 | 1 | |
| 1G 515 | 99003-20000 | DRIVER, PLUS, #3 | 1 | |
| 1G 516 | 99003-30000 | DRIVER, MINUS, #2 | 1 | |
| 1G 517 | 99003-40000 | LEVER | 1 | |
| 1G 518 | 99003-50000 | GRIP | 1 | |
| 1G 519 | 99004-18002 | WRENCH, PLUG BOX, 18.5 | 1 | |
| 1G 520 | 99005-02000 | BAR B, HANDLE | 1 | |
| 1G 521 | 99006-12000 | HANDLE, EYE WRENCH, 120MM | 1 | |
| 1G 522 | 99006-22000 | WRENCH, EYE, 22MM | 1 | |
| 1G 523 | 99007-45000 | SPANNER, PIN, 45MM | 1 | |
| 1G 524 | 99008-02000 | BAG, TOOL, 200MM | 1 | |
| 1B 525 | 87580-375-680A | MARK, DRIVE CAUTION | 1 | |

OEM PARTS & ACCESSORIES

Click on links below

[*Honda CB400F OEM Parts & Online Schematics*](#)

[*Honda Cruiser Parts & Accessories*](#)

[*Honda Motorcycle Parts & Accessories*](#)

[*Save Up to 45% on Motorcycle Tires*](#)

[*JC Whitney Motorcycle Parts & Accessories*](#)

[*Motorcycle Gear Closeout Sale*](#)

[*Mega Motor Madness*](#)

[*Cycle Gear Free Shipping*](#)



[*www.ClassicCycles.org*](http://www.ClassicCycles.org)